

LEGEND

○ = Corner having information on form 7100-52 in this file.

LEGEND CONFORMS TO REPORTING FORM

MPB

2/80

** RR R/W Mous at Back*

FILING INSTRUCTION

File 7100-52 card record by letter and number coordinates behind the file guide for the township in which it falls.

File the 7100-52 card record by letter and then by number i.e., all A cards first, then B cards etc.

The first card behind the file guide (if data have been obtained and recorded) will be card A-1 for N.W. Township Corner, then card A-2 for 1/16 corner then card A-3 for 1/4 corner etc.

Index
File No. 0151
CORNER RECORD (SEARCH) Contract or
(Ref. FSM 7151.4) Survey No. Cor. No. A-01
T 26 S. R. 8 E. R.D. Crescent County Klamath NW Cor. of
Merid. WILLAMETTE N.F. DESCHUTES State OREGON Section 6

SEE: Z-01 T. 25 S., R. 8 E., W.M.

BCSP

Index
File No. _____
T 26 S. R. 8 E. R.D. CRESCENT County KLAMATH Tract or Survey No. _____ Cor. No. A-05
Merid. WILLAMETTE N.F. DESCHUTES State OREGON

SEE: 2-05
T255 R8E

BC Jet

Index
File No. _____

CORNER RECORD (SEARCH)
(Ref. FSM 7151.4)

Tract or
Survey No. _____

Cor.
No. A-07

T 26 S. R. 8 E.

R.D. CRESCENT

County CLATSOP

Merid. WILLAMETTE

N.F. DESCHUTES

State OREGON

SEE: 2-07

T25S R8E

Bo Set

Index
File No. _____
T 26 S. R. 8 E. R.D. CRESCENT County KLAMATH
Merid. WILLAMETTE N.F. DESCHUTES State OREGON

CORNER RECORD (SEARCH)
(Ref. FSM 7151.4)

Tract or
Survey No. _____

Cor.
No. A-09

SEE: 2-09

T 255 R8E

B@ Set

Index
File No. A-13

CORNER RECORD (SEARCH)
(Ref. FSM 7151.4)

Tract or
Survey No. _____ Cor. No. A-13

T 26 S. R. 8 E. R.D. Crescent County Klamath

Merid. WILLAMETTE N.F. DESCHUTES State OREGON

See Z-13 T25S R8E
O

Index _____
File No. _____
T 26 S. R. 8 E. R.D. CRESCENT County KLAMATH Tract or Survey No. _____ Cor. No. A-25
Merid. WILLAMETTE N.F. DESCHUTES State OREGON

SEE: A-01

T265 R9E

BE

1 BT fd

Index File No. C-01

CORNER RECORD (SEARCH) Contract or
(Ref. FSM 7151.4) Survey No. _____

Cor. No. 0153

T 26 S. R. 8 E. R.D. CRESCENT

County KLAMATH

Merid. Willamette

N.F. Deschutes

State Oregon

Pol 3 Cor. of

Section 36

CORNER DIAGRAM, per legend

DESCRIBE CORNER MONUMENT FOUND

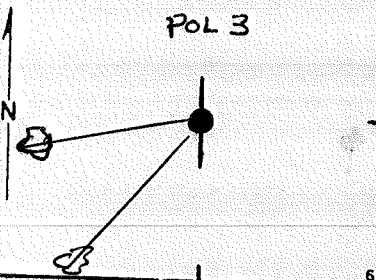

DESCRIBE BEARING TREES OR OTHER OFFICIAL ACCESSORIES FOUND

PHOTO IDENTIFICATION DATA

Photo No. _____
Filed At. _____
Object Ident. _____
Ident. By _____

DESCRIBE CORNER LOCATION RELATIVE TO NEAR-BY FEATURES, ALSO HOW TO REACH CORNER

CORNER LEGEND:

FS or	Unverified
Contr.	Other
○	◇ Searched For/Not Found
⊗	⊗ Evidence Found/Accept.
●	◆ Permanent Mon. Set/Fd.

Searched By: _____

Title _____

Division _____

Headquarters _____

Date 7/87

CORNER RECORD (PERPETUATION)

MONUMENT. DESCRIBE NEW MONUMENT SET, OR WORK DONE TO PRESERVE EXISTING MONUMENT

SET 5/8" X 30" I.R. WITH 1/2" ALUM CAP

SET GALV. STEEL POST 3.0 FT NORTH W/LSM

MONUMENT STAMPED

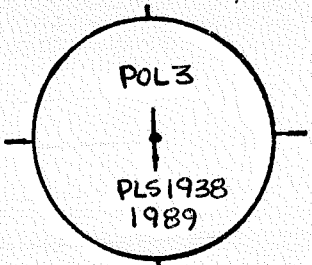

ACCESSORIES DESCRIBE NEW BT'S WITNESS OBJECTS ETC. ESTABLISHED, OR WORK DONE TO PRESERVE EXISTING EVIDENCE

7" ALPINE FIR S 76° W - 88.1 FT. (X BOT)

20" ALPINE FIR S 40° W - 101.6 FT (X BOT)

Work Done By FAST Title PLS Date 9/89 State Registration No. PLS-1938
or Agency

Platified Cor. Record Prepared Yes No Filed At KLAM. Co. Surveyor's Office Date

History
of
Surveys,
G.L.O.,
etc.

Index File No C-01 T. 26 S., R. 8 E., W.M. Contract or Surv. No Cor. 13

Index File No. _____
 T 26 S R. 8 E
 Merid. Willamette
 CORNER RECORD (SEARCH) (Ref. FSM 7151.4)
 R.D. Crescent County Klamath
 N.F. Deschutes State Oregon
 Tract or Survey No. 006686N Cor. No. C-5

CORNER DIAGRAM

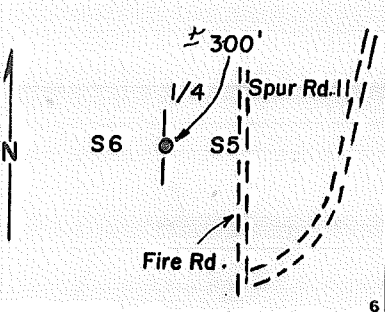

DESCRIBE CORNER MONUMENT FOUND

No original evidence found.
 FD 2 1/2" BC Buried 6" Below surface @ NW edge of RD.
 55' south of sign post

DESCRIBE BEARING TREES OR OTHER OFFICIAL ACCESSORIES FOUND

No original bearing trees found.
 FD 2 BT's (over)

PHOTO IDENTIFICATION DATA

Photo No. _____
 Filed At. _____
 Object Ident. _____
 Ident. By _____
 Signature _____

DESCRIBE CORNER LOCATION RELATIVE TO NEAR-BY FEATURES, ALSO HOW TO REACH CORNER

Take Hwy. 58 northerly from Jct. 58 & 97 to mile post 83.27.
 Take spur road 11 South + 1.7 miles to road Junction. Take
 right on road + 1600 feet. Corner is West + 300 feet.

PLANE COORDINATE POSITION DATA

State _____ Zone _____
 X _____
 Y _____
 Estab. By _____
 Agency _____

Signature James A. Tye Title Surveyor Division Sun Country Eng. & Surv. Headquarters Bend Off. Date 4-78 7100-52-(3/68)

CORNER RECORD (PERPETUATION)

MONUMENT: DESCRIBE NEW MONUMENT SET, OR WORK DONE TO PRESERVE EXISTING MONUMENT

Set 2½" galvanized iron pipe and 2½" brass cap.

T 26 S R 8 E

$\frac{1}{4}$ | S 5
 1978
 L.S. 1104
 ok 6/93

9

ACCESSORIES : DESCRIBE NEW BT'S WITNESS OBJECTS ETC. ESTABLISHED, OR WORK DONE TO PRESERVE EXISTING EVIDENCE

Scribed two bearing trees:

A ^{19"}~~7"~~ D.B.H. Lodgepole pine bears S 56° 40' W 46.10' ok
 A ^{19"}~~7"~~ D.B.H. ~~Lodgepole~~ pine bears S 83° E 94.44' ok
 PP

10

Work Done By James R. Tye Title Surveyor Date 4-78 State Registration No. L.S. 1104
 or Agency

Certified Cor. Record Prepared ? Yes No Filed At: _____ Date _____

11

REMARKS

Witness to corner:

Michael J. Yardley

Index File No. T. 26 S R. 8 E M. W. M. Tract or Surv. No. 00686 N Cor. C5

12

13

Index
File No. _____

CORNER RECORD (SEARCH)

(Ref. FSM 7151.4)

Tract or
Survey No. 006686N Cor. No. C 7

T 26 S R. 8 E R.D. Crescent County Klamath
Merid. Willamette N.F. Deschutes State Oregon

CORNER DIAGRAM

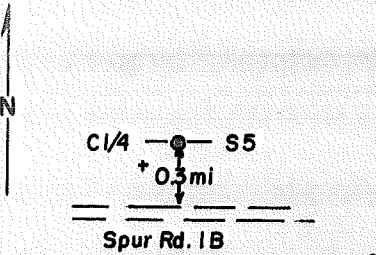

DESCRIBE CORNER MONUMENT FOUND

No original monument found.
FD BC in good condition (over) 6/93 sk

DESCRIBE BEARING TREES OR OTHER OFFICIAL ACCESSORIES FOUND

No original bearing trees found.
FD 2 BT's (over)

PHOTO IDENTIFICATION DATA

Photo No. _____
Filed At. _____
Object Ident. _____
Ident. By _____
Signature

DESCRIBE CORNER LOCATION RELATIVE TO NEAR-BY FEATURES, ALSO HOW TO REACH CORNER

Take Hwy. 58 northerly from Jct. 58 & 97 to approx. mile post 85.
Take spur road 1 $\pm \frac{1}{2}$ mile. Take spur road 1B west ± 0.8 mile
to boundary marker sign. Corner is ± 0.3 mile north.

PLANE COORDINATE POSITION DATA

State _____ Zone _____
X _____
Y _____
Estab. By _____
Agency

Signature *James R. Tye* Title *Surveyor* Division *Sun Country Eng. & Surv.* Headquarters *Bend Off.* Date *4-78* 7100-52 (3,68)

CORNER RECORD (PERPETUATION)

MONUMENT: DESCRIBE NEW MONUMENT SET, OR WORK DONE TO PRESERVE EXISTING MONUMENT

Set 2½" galvanized iron pipe and 2½" brass cap.

T 26 S R 8 E

C ¼ S 5 ok

1978

L.S. 1104

9

ACCESSORIES : DESCRIBE NEW BT'S WITNESS OBJECTS ETC. ESTABLISHED, OR WORK DONE TO PRESERVE EXISTING EVIDENCE

Scribed two bearing trees:

An 8" D.B.H. Lodgepole pine bears N 81° 20' East 57.50' ok

A 9" D.B.H. Lodgepole pine bears S 10° 40' East 20.56' ok

10

Work Done By James R. Tye Title Surveyor Date 4-78 State Registration No. LS 1104
or Agency

Certified Cor. Record Prepared ? Yes No Filed At: _____ Date _____

11

REMARKS

Witness to corner:

Michael J. Yardley

Revisited 5188 By K. Greer - FOUND BC and 2 BTs in good condition

Index File No. T. 26 S R. 8 E M. W.M. Tract or Surv. No. 00686 Cor. C7

12

13

Index
File No. _____

CORNER RECORD (SEARCH)

(Ref. FSM 7151.4)

Tract or
Survey No. 006686N

Cor.
No. C-9

T 26 S R. 8 E

R.D. Crescent County Klamath

Merid. Willamette

N.F. Deschutes State Oregon

CORNER DIAGRAM

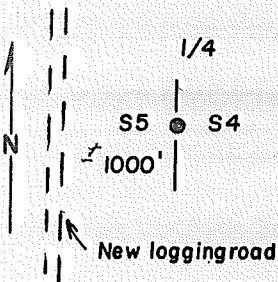

DESCRIBE CORNER MONUMENT FOUND

No original monument found.

DESCRIBE BEARING TREES OR OTHER OFFICIAL ACCESSORIES FOUND

No original bearing tree evidence found.

PHOTO IDENTIFICATION DATA

Photo No. _____
Filed At. _____
Object Ident. _____
Ident. By _____
Signature

DESCRIBE CORNER LOCATION RELATIVE TO NEAR-BY FEATURES, ALSO HOW TO REACH CORNER

Take Hwy. 58 northerly from Jct. 58 & 97 to approx. mile post 83.28. Take spur road 11 South + 0.3 mile. Take new logging road Southeasterly + 4700'. Corner is + 1000' East.

PLANE COORDINATE POSITION DATA

State _____ Zone _____
X _____
Y _____
Estab. By _____
Agency

Signature

Title

Division

Headquarters

Date

7100-52 (3/68)

James R. Vye

Surveyor

Sun Country Eng. & Surv.

Bend Off.

4-78

CORNER RECORD (PERPETUATION)

MONUMENT: DESCRIBE NEW MONUMENT SET, OR WORK DONE TO PRESERVE EXISTING MONUMENT

Set 2½" galvanized iron pipe and 2½" brass cap.

T 26 S R 8 E
 S 5 | S 4
 1978
 L.S. 1104

9

ACCESSORIES : DESCRIBE NEW BT'S WITNESS OBJECTS ETC. ESTABLISHED, OR WORK DONE TO PRESERVE EXISTING EVIDENCE

Scribed two new bearing trees:

A 7" D.B.H. Lodgepole pine bears N 49° 30' W 30.76' .
 An 8" D.B.H. Lodgepole pine bears S 85° 40' E 45.24'

10

Work Done By James R. Tye Title Surveyor Date 4-78 State Registration No. L.S. 1104
 or Agency _____

Certified Cor. Record Prepared ? Yes No Filed At: _____ Date _____

11

REMARKS

Witness to corner:

Michael J. Yardley

Index File No.

T. 26 S

R. 8 E

M. W. M.

Tract or Surv. No. 00686 N

Cor. 015

2-09

12

Index
File No. 2553 CORNER RECORD (SEARCH) Contract or
(Ref. FSM 7151.4) Survey No. Cor. No. C-25
T 26 S. R. 8 E. R.D. CRESCENT County KLAMATH E/4 Cor. of
Merid. WILLAMETTE N.F. DESCHUTES State OREGON Section 1

SEE: C-01 T. 26 S., R. 9 E., W.M.

BC

C-25

Index
File No. E-~~1~~ 1

CORNER RECORD (SEARCH)

(Ref. FSM 7151.4)

Tract or
Survey No. _____ Cor. No. E-01

T 26 S R. 8 E R.D. Crescent County Klamath

Merid. W. N.F. Deschutes State Ore.

CORNER DIAGRAM

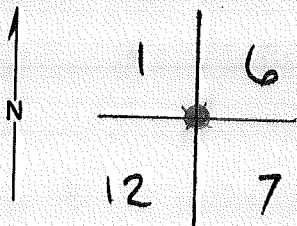

DESCRIBE CORNER MONUMENT FOUND

See: T 26 S, R 7 E, E-25

DESCRIBE BEARING TREES OR OTHER OFFICIAL ACCESSORIES FOUND

B.C.

PHOTO IDENTIFICATION DATA

Photo No. _____
Filed At. _____
Object Ident. _____
Ident. By _____

Signature

PLANE COORDINATE POSITION DATA

State _____ Zone _____
X _____
Y _____
Estab. By _____

Agency

Signature

Title

Division

Headquarters

Date

7100-52 (3/68)

CORNER RECORD (PERPETUATION)

MONUMENT : DESCRIBE NEW MONUMENT SET, OR WORK DONE TO PRESERVE EXISTING MONUMENT

9

ACCESSORIES : DESCRIBE NEW BT's WITNESS OBJECTS ETC. ESTABLISHED, OR WORK DONE TO PRESERVE EXISTING EVIDENCE

10

Work Done By Bob Elliott Title Const. Insp Date 10-8-70 State Registration No. or Agency _____
Certified Cor. Record Prepared ? Yes No Filed At: _____ Date _____

11

REMARKS

Index File No. T. R. M. Tract or Surv. No. Cor. E-01

12

13

Index
File No. 0355

CORNER RECORD (SEARCH)

(Ref. FSM 7151.4)

Tract or Survey No. 006686N Cor. No. E 3

T 26 S R. 8 E

R.D. Crescent County Klamath

Merid. Willamette

N.F. Deschutes State Oregon

CORNER DIAGRAM

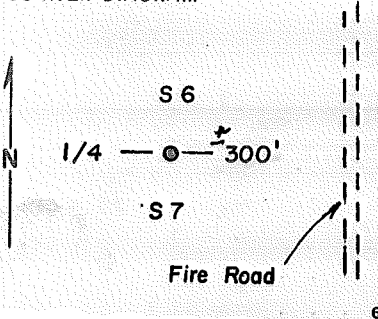

DESCRIBE CORNER MONUMENT FOUND

No original monument found.

DESCRIBE BEARING TREES OR OTHER OFFICIAL ACCESSORIES FOUND

No original bearing trees found.

PHOTO IDENTIFICATION DATA

Photo No. _____
Filed At. _____
Object Ident. _____
Ident. By _____
Signature

DESCRIBE CORNER LOCATION RELATIVE TO NEAR-BY FEATURES, ALSO HOW TO REACH CORNER

Take Hwy. 58 northerly from Jct. 58 & 97 to approx. mile post 82. Take road 254 to Emigrant Crossing. Take road # 2521 \pm 1.9 miles to SW corner Section 6. Take fire road easterly. Road winds back to North across clear cut area. Road forks at creek crossing. Take South fork \pm $\frac{1}{4}$ mile. Corner is \pm 200' West.

PLANE COORDINATE POSITION DATA

State _____ Zone _____
X _____
Y _____
Estab. By _____
Agency

Signature
James R. Tye

Title Surveyor Division Sun Country Eng. & Surv. Headquarters Bend Off.

Date 4-78 7100-52-(3/68)

CORNER RECORD (PERPETUATION)

MONUMENT: DESCRIBE NEW MONUMENT SET, OR WORK DONE TO PRESERVE EXISTING MONUMENT

Set 2½" galvanized iron pipe and 2½" brass cap.

T 26 S R 8 E
 ¼ S 6
 S 7
 1978
 L.S. 1104

9

ACCESSORIES : DESCRIBE NEW BT'S WITNESS OBJECTS ETC. ESTABLISHED, OR WORK DONE TO PRESERVE EXISTING EVIDENCE

Scribed two bearing trees:

A 9" D.B.H. Lodgepole pine bears S 31° E 69.18'

A 9" D.B.H. Lodgepole pine bears N 71° W 19.60' BT FOUND STANDING DEAD (8/87)

NEW BT:

A 9" L.P.P. bears N 12° 26' E @ 55.40' to A 60-d spike in NW base, MKD ¼S6BT 10

Work Done By James R. Tye Title Surveyor Date 4=78 State Registration No. L.S. 1104
 or Agency

Certified Cor. Record Prepared ? Yes No Filed At: _____ Date _____ 11

REMARKS

(8/87) Mtc. by Walt Miller - PLS 2111
 Refer to plat # 000749

Witness to corner:

Michael J. Yardley

Index File No. T. 26S R. 8E M. W.M. Tract or Surv. No. 00686N Cor. E 3 12
 13

Index
File No. _____

CORNER RECORD (SEARCH)

(Ref. FSM 7151.4)

Tract or Survey No. 006686N Cor. No. E 5

T 26 S R. 8 E R.D. Crescent County Klamath
Merid. Willamette N.F. Deschutes State Oregon

CORNER DIAGRAM

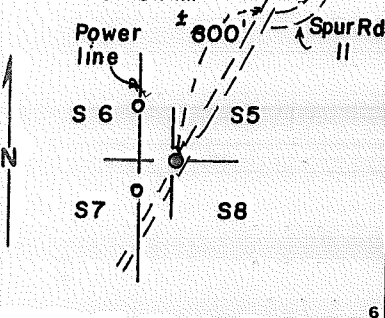

DESCRIBE CORNER MONUMENT FOUND

No original evidence found.

DESCRIBE BEARING TREES OR OTHER OFFICIAL ACCESSORIES FOUND

No original bearing trees found.

FD 4 BT's 6/93 (over) sk

PHOTO IDENTIFICATION DATA

Photo No. _____
Filed At. _____
Object Ident. _____
Ident. By _____
Signature

PLANE COORDINATE POSITION DATA

State _____ Zone _____
X _____
Y _____
Estab. By _____
Agency

DESCRIBE CORNER LOCATION RELATIVE TO NEAR-BY FEATURES, ALSO HOW TO REACH CORNER

Take Hwy. 58 northerly from Jct. 58 & 97 to mile post 83.28.
Take spur road 11 South ± 1.9 miles to corner. Corner falls in road.

Signature James A. Tyle Title Surveyor Division Sun Country Eng. & Surv. Headquarters Bend Off. Date 4-78 7100-52-(3/68)

CORNER RECORD (PERPETUATION)

MONUMENT: DESCRIBE NEW MONUMENT SET, OR WORK DONE TO PRESERVE EXISTING MONUMENT

Set 2½" galvanized iron pipe and 2½" brass cap
buried 8" below road surface.

T 26 S R 8 E
 S 6 | S 5
 S 7 | S 8
 1978
 L.S. 1104

9

ACCESSORIES : DESCRIBE NEW BT'S WITNESS OBJECTS ETC. ESTABLISHED, OR WORK DONE TO PRESERVE EXISTING EVIDENCE

Scribed four bearing trees:

An 8" D.B.H. Lodgepole pine bears S 67° E 53.39' *OK*
 A 10" D.B.H. Lodgepole pine bears S 24° W 72.00' *"*
 A 7" D.B.H. Lodgepole pine bears N 55° 10' W 104.95' *"*
 A 9" D.B.H. Lodgepole pine bears N 41° 40' E 43.38' *"*

10

Work Done By James R. Tye Title Surveyor Date 4-78 State Registration No. L.S. 1104
 or Agency _____

Certified Cor. Record Prepared ? Yes No Filed At: _____ Date _____ 11

REMARKS

Witness to corner:

Michael J. Yardley

Index File No.

T. 26 S

R. 8 E

M. W. M.

Tract or Surv. No. 00686N

Cor. E 5

12

13

Index
File No. _____

CORNER RECORD (SEARCH)

(Ref. FSM 7151.4)

Tract or
Survey No. 006686N Cor. No. E 7

T 26 S R. 8 E R.D. Crescent County Klamath

Merid. Willamette N.F. Deschutes State Oregon

CORNER DIAGRAM

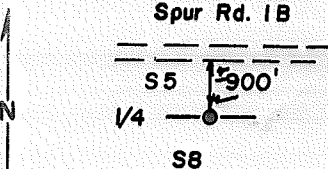

DESCRIBE CORNER MONUMENT FOUND

No original monument found.
FD 2 1/2" BC rising 3" in good condition
6/93 SK

T26S R8E
1/4 S5
S8
1978
LS/104

DESCRIBE BEARING TREES OR OTHER OFFICIAL ACCESSORIES FOUND

No original bearing trees found.
FD 2 BTs (over)

PHOTO IDENTIFICATION DATA

Photo No. _____
Filed At. _____
Object Ident. _____
Ident. By _____
Signature _____

DESCRIBE CORNER LOCATION RELATIVE TO NEAR-BY FEATURES, ALSO HOW TO REACH CORNER

Take Hwy 58 northerly from Jct. 58 & 97 to mile post 85. Take spur road 1 south + 1/2 mile to spur road 1B. Take 1B + 4200 feet. Corner is + 900' south.

PLANE COORDINATE POSITION DATA

State _____ Zone _____
X _____
Y _____
Estab. By _____
Agency _____

Signature James R. Tye Title Surveyor Division Sun Country Eng. & Surv. Headquarters Bend Off, Date 4-78 7100-52-(3/68)

CORNER RECORD (PERPETUATION)

MONUMENT: DESCRIBE NEW MONUMENT SET, OR WORK DONE TO PRESERVE EXISTING MONUMENT

Set 2½" galvanized iron pipe and 2½" brass cap by
single proportion.

T 26 S R 8 E

¼ $\frac{S\ 5}{S\ 8}$ ok

1978
L.S. 1104

9

ACCESSORIES : DESCRIBE NEW BT's WITNESS OBJECTS ETC. ESTABLISHED, OR WORK DONE TO PRESERVE EXISTING EVIDENCE

Scribed two bearing trees:

A 6" D.B.H. Lodgepole Pine S 43° 50' E 36.54' ok

A 7" D.B.H. Lodgepole Pine N 48° 00' E 36.26' ok

10

Work Done By James R. Tye Title Surveyor Date 4-78 State Registration No. L.S. 1104
or Agency

Certified Cor. Record Prepared? Yes No Filed At: _____ Date _____

11

REMARKS

Witness to corner:

Michael J. Yardley

Index File No.

T. 26S

R. 8 E

M. W. M.

Tract or Surv. No. 00686 N

Cor. E 7

12

13

Index

File No.

CORNER RECORD (SEARCH)

(Ref. FSM 7151.4)

Tract or

Survey No.

006686N

Cor.

No. E 9

T 26 S R. 8 E

R.D. Crescent County

Klamath

Merid. Willamette

N.F. Deschutes State Oregon

CORNER DIAGRAM

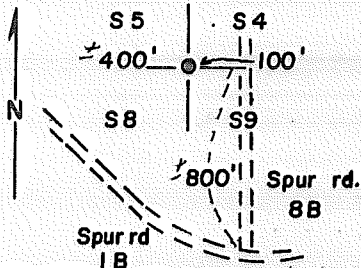

DESCRIBE CORNER MONUMENT FOUND

No original monument found.

4/97 - Found BCSP lying on the ground at the foot of a root wad from a LPP. which blew over. Re-established cap from BTs. See updated Cert. 2

DESCRIBE BEARING TREES OR OTHER OFFICIAL ACCESSORIES FOUND

No original bearing tree evidence found.

PHOTO IDENTIFICATION DATA

Photo No. _____

Filed At. _____

Object Ident. _____

Ident. By _____

Signature 7

PLANE COORDINATE POSITION DATA

State _____ Zone _____

X _____

Y _____

Estab. By _____

Agency 8

DESCRIBE CORNER LOCATION RELATIVE TO NEAR-BY FEATURES, ALSO HOW TO REACH CORNER 3

Take Hwy. 58 northerly from Jct. 58 & 97 to mile post 85. Take spur road 1 southwesterly + $\frac{1}{2}$ mile to spur road 1-B. Take 1-B northwesterly + 1800 feet. Corner is + 400 feet East. Or take spur road 8-B as shown in diagram.

Signature

Title

Division

Headquarters

Date

7100-52-(3/68)

James R. Tye

Surveyor

Sun Country Eng & Surv. Bend Off.

4-78

5

CORNER RECORD (PERPETUATION)

MONUMENT: DESCRIBE NEW MONUMENT SET, OR WORK DONE TO PRESERVE EXISTING MONUMENT

Set 2½" galvanized iron pipe and 2½" brass cap.

T 26 S		Ra 8 E
S 5		S 4
S 8		S 9
1978		
L.S. 1104		

Set Steel Fence Post 3 Ft. S.

ACCESSORIES: DESCRIBE NEW BT'S WITNESS OBJECTS ETC. ESTABLISHED, OR WORK DONE TO PRESERVE EXISTING EVIDENCE

Scribed four new bearing trees:

- 4/97
- A 9" D.B.H. Lodgepole pine bears N 26° 40' W 69.22' - stump
 - A 10" D.B.H. Lodgepole pine bears N 60° 10' E 59.21' - wind fall
 - An 8" D.B.H. Lodgepole pine bears S 63° 30' E 50.30' stands green
 - A 7" D.B.H. Lodgepole pine bears S 69° 30' W 61.23' gone.

Work Done By James R. Tye Title Surveyor Date 4-78 State Registration No. L.S. 1104
or Agency

Certified Cor. Record Prepared? Yes No Filed At: _____ Date _____

REMARKS *New BTs*

Witness to corner:

Michael J. Yardley

- P.P. 10" dia N 15° E 105 ⁸/₁₀ ft. mkd X BT
- L.P.P. 5" dia. S 15° W 212 ft mkd X BT
- P.P. 44" dia. N 53° W 127 ⁹/₁₀ ft mkd T26SR8ESS BT
(Double Top)

Index
File No. _____

CORNER RECORD (SEARCH)

(Ref. FSM 7151.4)

Tract or Survey No. 006686N Cor. No. E 11

T 26 S R. 8 E
Merid. Willamette

R.D. Crescent m County Klamath
N.F. Deschutes State Oregon

CORNER DIAGRAM

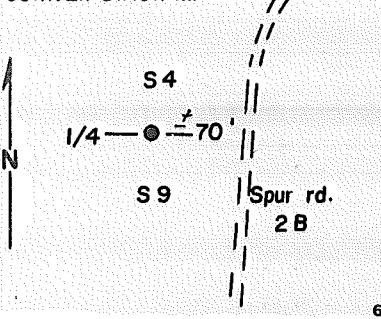

DESCRIBE CORNER MONUMENT FOUND

No original monument found.

2

DESCRIBE BEARING TREES OR OTHER OFFICIAL ACCESSORIES FOUND

No original bearing tree evidence found.

3

PHOTO IDENTIFICATION DATA

Photo No. _____
Filed At. _____
Object Ident. _____
Ident. By _____
Signature

DESCRIBE CORNER LOCATION RELATIVE TO NEAR-BY FEATURES, ALSO HOW TO REACH CORNER

Take Hwy. 58 northerly from Jct. 58 & 97 + 1/2 mile to State gravel pit road. Take road South + 3/4 mile to spur road 2B. Take 2B back North + 1 mile to corner.

4

PLANE COORDINATE POSITION DATA

State _____ Zone _____
X _____
Y _____
Estab. By _____
Agency

Signature
James R. Tye

Title Surveyor Division Sun Country Eng. & Surv. Headquarters Bend Off. Date 7100-52-(3/68)

5

CORNER RECORD (PERPETUATION)

MONUMENT: DESCRIBE NEW MONUMENT SET, OR WORK DONE TO PRESERVE EXISTING MONUMENT

Set 2½" galvanized iron pipe and 2½" brass cap by single proportion.

T 26 S R 8 E
 S 4
 ¼ —
 S 9
 1978
 I.S. 1104

9

ACCESSORIES : DESCRIBE NEW BT'S WITNESS OBJECTS ETC. ESTABLISHED, OR WORK DONE TO PRESERVE EXISTING EVIDENCE

Scribed two new bearing trees:

A 7" D.B.H. Lodgepole pine bears N 25° 45' E 57.23'
 A 6" D.B.H. Lodgepole pine bears S 14° E 10.13'

10

Work Done By James R. Tye Title Surveyor Date 4-78 State Registration No. I.S. 1104
 or Agency

Certified Cor. Record Prepared ? Yes No Filed At: _____ Date _____

11

REMARKS

Witness to corner:

Michael J. Yardley

Index File No. T. 26 S R. 8 E M. W. M. Tract or Surv. No. 00686 N Cor. E 11

12

13

Index
File No. _____

CORNER RECORD (SEARCH)

(Ref. FSM 7151.4)

Tract or
Survey No. 006686N Cor.
No. E 13T 26 S R. 8 E R.D. Crescent County Klamath
Merid. Willamette N.F. Deschutes State Oregon

CORNER DIAGRAM

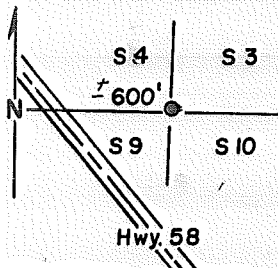

PHOTO IDENTIFICATION DATA

Photo No. _____
Filed At. _____
Object Ident. _____
Ident. By _____
Signature

PLANE COORDINATE POSITION DATA

State _____ Zone _____
X _____
Y _____
Estab. By _____
Agency

DESCRIBE CORNER MONUMENT FOUND

No original corner monument found.

DESCRIBE BEARING TREES OR OTHER OFFICIAL ACCESSORIES FOUND

Found 1 original bearing tree standing.

Found 3 original bearing trees dead and down.

14" (original) D.B.H. Lodgepole pine bears S 65° E 24.40'

DESCRIBE CORNER LOCATION RELATIVE TO NEAR-BY FEATURES, ALSO HOW TO REACH CORNER

Take Hwy. 58 Northerly from Jct. 58 & 97 ± 0.70 mile to section line sign board. Corner is ± 600' East on line.

Signature

James R. Tye

Title

Surveyor

Division

Sun Country Eng. & Surv.

Headquarters

Bend Off.

Date

4 - 78

7100-52-(3/68)

5

CORNER RECORD (PERPETUATION)

MONUMENT: DESCRIBE NEW MONUMENT SET, OR WORK DONE TO PRESERVE EXISTING MONUMENT

Set 2½" galvanized iron pipe and 2½" brass cap from original bearing tree evidence.

T 26 S R 8 E
 S 4 | S 3
 S 9 | S 10
 1978
 L.S. 1104

9

ACCESSORIES : DESCRIBE NEW BT'S WITNESS OBJECTS ETC. ESTABLISHED, OR WORK DONE TO PRESERVE EXISTING EVIDENCE

Painted 14" D.B.H. Original Lodgepole pine which bears S 65° E 24.40'
 Scribed three new bearing trees:

- An 8" D.B.H. Lodgepole pine bears S 22° 30' W 13.65'
- A 10" D.B.H. Lodgepole pine bears N 43° 20' W 49.42'
- A 6" D.B.H. Lodgepole pine bears N 46° E 82.00'

10

Work Done By James R. Tye Title Surveyor Date 4-78 State Registration No. L.S. 1104
 or Agency

Certified Cor. Record Prepared ? Yes No Filed At: _____ Date _____

11

REMARKS

Witness to corner:

Michael J. Yardley

REVISITED: 6-5-84 BY SC/LS ST's

Index File No. T. 26S R. 8E M.W.M. Tract or Surv. No. 00686 N Cor. E 13

12

13

Index
File No. 2555 CORNER RECORD (SEARCH) Contract or
(Ref. FSM 7151.4) Survey No.
T 26 S. R. 8 E. R.D. CRESCENT County KLAMATH Cor. No. E-25
Merid. WILLAMETTE N.F. DESCHUTES State OREGON Section 1 Cor. of

SEE: E-01 T. 26 S., R. 9 E., W.M.

TBC

E-25

Index
File No. _____

CORNER RECORD (SEARCH)
(Ref. FSM 7151.4)

Tract or
Survey No. 006686N Cor. No. G-1

T 26 S R. 8 E

R.D. Crescent County Klamath

Merid. Willamette

N.F. Deschutes State Oregon

CORNER DIAGRAM

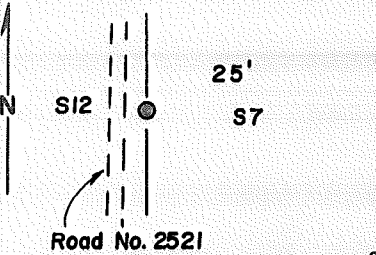

DESCRIBE CORNER MONUMENT FOUND

No original monument found.

DESCRIBE BEARING TREES OR OTHER OFFICIAL ACCESSORIES FOUND

Found one original bearing tree.

41" Ponderosa Pine bears S 7° E 36.96'

PHOTO IDENTIFICATION DATA

Photo No. _____
Filed At. _____
Object Ident. _____
Ident. By _____
Signature

DESCRIBE CORNER LOCATION RELATIVE TO NEAR-BY FEATURES, ALSO HOW TO REACH CORNER

Take Hwy. 58 Northerly from Jct. 58 & 97 to approx. mile post 82.
Take road # 254 + 1.7 miles to Emigrant crossing. Take road #2521
South + 2.3 miles. Corner is + 25' East.

PLANE COORDINATE POSITION DATA

State _____ Zone _____
X _____
Y _____
Estab. By _____
Agency

Signature James R. V. [Signature]

Title Surveyor Division Sun Country Eng. & Surv. Headquarters Bend Off. Date 4-78 7100-52-(3/68)

CORNER RECORD (PERPETUATION)

MONUMENT: DESCRIBE NEW MONUMENT SET, OR WORK DONE TO PRESERVE EXISTING MONUMENT

Set 2½" galvanized iron pipe and 2½" brass cap marked:

T 26 S
R 7 E R 8 E
 ¼
S 12 | S 7
 1978

9

ACCESSORIES : DESCRIBE NEW BT'S WITNESS OBJECTS ETC. ESTABLISHED, OR WORK DONE TO PRESERVE EXISTING EVIDENCE

Scribed two new bearing trees:

An 8" Lodgepole pine bears S 86° 50' W 63.62'

An 8" Ponderosa pine bears N 75° E 94.64'

10

Work Done By James R. Tye Title Surveyor Date 4-78 State Registration No. L.S. 1104
or Agency

Certified Cor. Record Prepared? Yes No Filed At: _____ Date _____

11

REMARKS

Witness to corner:

Michael J. Yardley

Revisited 5/88. BY R. Greer FD BC and 3 BTs

12

Index File No.

T. 26 S

R. 8 E

M. W.M.

Tract or Surv. No. 00686 N

Cor. G I

13

Index
File No. _____

CORNER RECORD (SEARCH)
(Ref. FSM 7151.4)

Tract or
Survey No. 006686N Cor. No. G 5

T 26 S R. 8 E

R.D. Crescent County Klamath

Merid. Willamette

N.F. Deschutes State Oregon

CORNER DIAGRAM

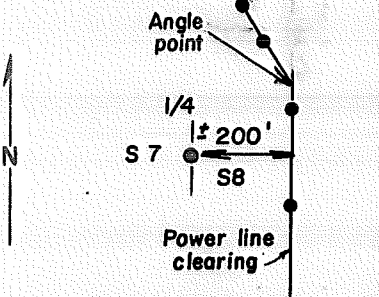

DESCRIBE CORNER MONUMENT FOUND

No original evidence found.
FD 2 1/2" BC Filing 4" in good condition

T26S8E
S7 1/4
S8
1778
LS1104

DESCRIBE BEARING TREES OR OTHER OFFICIAL ACCESSORIES FOUND

No original bearing trees found.
FD 2 BTs (over)

PHOTO IDENTIFICATION DATA

Photo No. _____
Filed At. _____
Object Ident. _____
Ident. By _____
Signature _____

DESCRIBE CORNER LOCATION RELATIVE TO NEAR-BY FEATURES, ALSO HOW TO REACH CORNER

Take Hwy. 58 northerly from Jct. 58 & 97 to approx. mile post 83.27. Take spur road 11 South ± 2.3 miles along power line clearing. Corner is ± 200' West.

PLANE COORDINATE POSITION DATA

State _____ Zone _____
X _____
Y _____
Estab. By _____
Agency _____

Signature
James R. Tye

Title
Surveyor

Division
Bend Office

Headquarters
Sun Country Eng. & Surv.

Date
4-78

7100-52-(3/68)

1
2
3
4
5

CORNER RECORD (PERPETUATION)

MONUMENT: DESCRIBE NEW MONUMENT SET, OR WORK DONE TO PRESERVE EXISTING MONUMENT

Set 2½" galvanized iron pipe and 2½" brass cap.

T 26 S R 8 E

S 7 | S 8
 1978

L.S. 1104

9

ACCESSORIES : DESCRIBE NEW BT'S WITNESS OBJECTS ETC. ESTABLISHED, OR WORK DONE TO PRESERVE EXISTING EVIDENCE

Scribed two bearing trees:

An 8" D.B.H. Lodgepole pine bears N 84° 20' E 75.12'

A 7" D.B.H. Lodgepole pine bears S 75° 30' W 67.72'

10

Work Done By James R. Tye Title Surveyor Date 4-78 State Registration No. or Agency L.S. 1104

Certified Cor. Record Prepared ? Yes No Filed At: _____ Date _____

11

REMARKS

Witness to corner:

Michael J. Yardley

12

Index File No. T. 26 S R. 8 E M. W. M. Tract or Surv. No. 00686N Cor. G 5

13

Index
File No. _____

CORNER RECORD (SEARCH)

(Ref. FSM 7151.4)

Tract or
Survey No. 006686N Cor. No. G 7

T 26 S R. 8 E R.D. Crescent County Klamath

Merid. Willamette N.F. Deschutes State Oregon

CORNER DIAGRAM

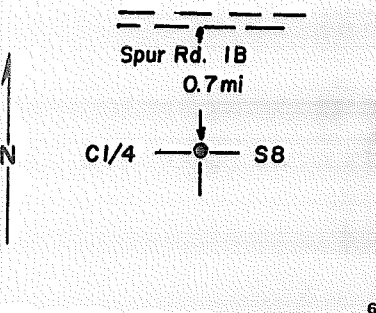

DESCRIBE CORNER MONUMENT FOUND

None
FD BC 6/93 sk (over) rising 4"
T26S R8E
C1/4 + S8
1978
LS 1104

DESCRIBE BEARING TREES OR OTHER OFFICIAL ACCESSORIES FOUND

None
FD 2 BT's (over)

PHOTO IDENTIFICATION DATA

Photo No. _____
Filed At. _____
Object Ident. _____
Ident. By _____
Signature _____

DESCRIBE CORNER LOCATION RELATIVE TO NEAR-BY FEATURES, ALSO HOW TO REACH CORNER

Take Hwy 58 northerly from Jct. 58 & 97 to approx. mile post 85. Take spur road 1 + 1/2 mile. Take spur road 1B West + 0.8 mile to boundary marker sign. Corner is + 0.7 mile South.

PLANE COORDINATE POSITION DATA

State _____ Zone _____
X _____
Y _____
Estab. By _____
Agency _____

Signature James R. Tye Title Surveyor Division Bend Off. Headquarters Sun Country Eng. & Surv. Date 4-78 7100-52-(3/68)

CORNER RECORD (PERPETUATION)

MONUMENT: DESCRIBE NEW MONUMENT SET, OR WORK DONE TO PRESERVE EXISTING MONUMENT

Set 2½" galvanized iron pipe and 2½" brass cap.

T 26 S R 8 E



1978

L.S. 1104

9

ACCESSORIES : DESCRIBE NEW BT'S WITNESS OBJECTS ETC. ESTABLISHED, OR WORK DONE TO PRESERVE EXISTING EVIDENCE

Scribed two bearing trees:

An 8" DBH Lodgepole Pine bears S 28° 10' W 60.84' ok

An 8" DBH Lodgepole Pine bears S 47° 00' E 21.44' Down Dead 6/93

Steel posts 2' N ; 2' W of cor

10

Work Done By James R. Tye Title Surveyor Date 4-78 State Registration No. LS 1104
or Agency _____

Certified Cor. Record Prepared ? Yes No Filed At: _____ Date _____ 11

REMARKS

Witness to corner:

Michael J. Yardley

Index File No.

T. 26 S

R. 8 E

M. W. M.

Tract or Surv. No. 00686 N

Cor. 67

12

13

Index
File No. _____

CORNER RECORD (SEARCH)
(Ref. FSM 7151.4)

Tract or
Survey No. 006686N Cor. No. G 9

T 26 S R. 8 E

R.D. Crescent County Klamath

Merid. Willamette

N.F. Deschutes State Oregon

CORNER DIAGRAM

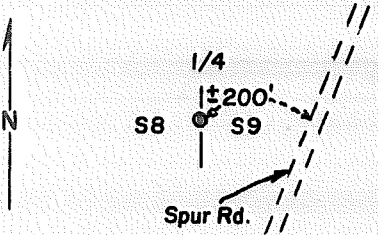

DESCRIBE CORNER MONUMENT FOUND

No original evidence found.

DESCRIBE BEARING TREES OR OTHER OFFICIAL ACCESSORIES FOUND

No original bearing trees found.

PHOTO IDENTIFICATION DATA

Photo No. _____
Filed At. _____
Object Ident. _____
Ident. By _____
Signature

DESCRIBE CORNER LOCATION RELATIVE TO NEAR-BY FEATURES, ALSO HOW TO REACH CORNER

Take Hwy. 58 northerly from Jct. 58 & 97 to approx. mile post 85. Take spur road 1 South ± 1 mile. Corner is ± 200 ' West.

PLANE COORDINATE POSITION DATA

State _____ Zone _____
X _____
Y _____
Estab. By _____
Agency

Signature James R. Tye

Title
Surveyor

Division
Bend Office

Headquarters
Sun Country Eng. & Surv.

Date
4-78

7100-52-(3/68)

CORNER RECORD (PERPETUATION)

MONUMENT: DESCRIBE NEW MONUMENT SET, OR WORK DONE TO PRESERVE EXISTING MONUMENT

Set 2½" galvanized iron pip and 2½" brass cap.

T 26 S R 8 E

S 8 | S 9

1978

L.S. 1104

9

ACCESSORIES : DESCRIBE NEW BT's WITNESS OBJECTS ETC. ESTABLISHED, OR WORK DONE TO PRESERVE EXISTING EVIDENCE

Scribed two bearing trees:

An 11" D.B.H. Lodgepole pine bears N 87° 30' E 66.21'

A 7" D.B.H. Lodgepole pine bears S 33° 20' W 23.92'

10

Work Done By James R. Tye Title Surveyor Date 4-78 State Registration No. L.S. 1104
or Agency _____

Certified Cor. Record Prepared ? Yes No _____ Filed At: _____ Date _____

11

REMARKS

Witness to corner:

Michael J. Yardley

12

Index File No. T. 26S R. 8E M. W. M. Tract or Surv. No. 00686N Cor. 69

13

Index File No. 1357
T 26 S. R. 8 E. R.D. Crescent
Merid. Willamette N.F. Deschutes

CORNER RECORD (SEARCH) (Ref. FSM 7151.4)
Contract or Survey No. _____
County Klamath State Oregon

Cor. No. G-13
w/4 Cor. of Section 10

CORNER DIAGRAM per legend

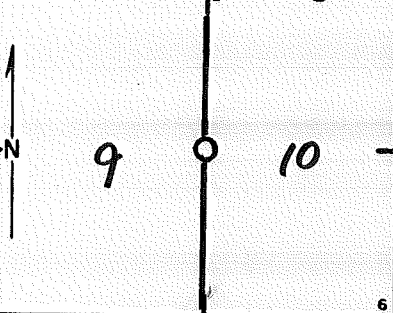

DESCRIBE CORNER MONUMENT FOUND

SFNF

DESCRIBE BEARING TREES OR OTHER OFFICIAL ACCESSORIES FOUND

SFNF

PHOTO IDENTIFICATION DATA

Photo No. _____
Filed At. _____
Object Ident. _____
Ident. By _____
Signature

LOCATION FALLS IN PIPE-LINE CLEARING

DESCRIBE CORNER LOCATION RELATIVE TO NEAR-BY FEATURES, ALSO HOW TO REACH CORNER

CORNER LEGEND:

- | | | |
|-------------------------------------|-------------------------------------|------------------------|
| FS or Contr. | Unverified Other | |
| <input type="radio"/> | <input type="checkbox"/> | Searched For/Not Found |
| <input checked="" type="checkbox"/> | <input checked="" type="checkbox"/> | Evidence Found/Accept. |
| <input type="checkbox"/> | <input type="checkbox"/> | Permanent Mon. Set/Fd. |

Searched By: _____ Title _____ Division _____ Headquarters _____ Date _____

SC/GS

ST CS

SO

6-6-84

CORNER RECORD (PERPETUATION)

MONUMENT: DESCRIBE NEW MONUMENT SET, OR WORK DONE TO PRESERVE EXISTING MONUMENT

MONUMENT STAMPED

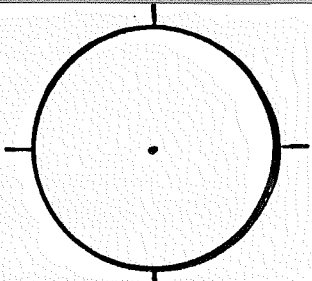

ACCESSORIES : DESCRIBE NEW BT'S WITNESS OBJECTS ETC. ESTABLISHED, OR WORK DONE TO PRESERVE EXISTING EVIDENCE

Work Done By _____ Title _____ Date _____ State Registration No. or Agency _____
Plat or Certified Cor. Record Prepared? Yes No Filed At: _____ Co. Surveyor's Office Date _____

History
of
Surveys,
G.L.O.,
etc.

Index File No. 1357 T. 26 S., R. 8 E., W.M.

Contract or Surv. No.

Cor. G-13

Index
File No. 0159

CORNER RECORD (SEARCH)

(Ref. FSM 7151.4)

Tract or Survey No. 006686N Cor. No. J 1

T 26 S R. 8 E

R.D. Crescent County Klamath SW COR

Merid. Willamette

N.F. Deschutes State Oregon Sec. 7

CORNER DIAGRAM

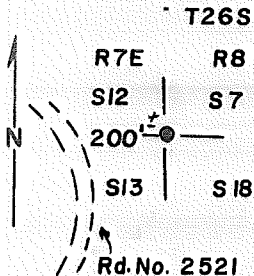

DESCRIBE CORNER MONUMENT FOUND

No original monument found.

DESCRIBE BEARING TREES OR OTHER OFFICIAL ACCESSORIES FOUND

Found one original bearing tree stump cut down by logging activity bears N 10° W 23.76 feet.

PHOTO IDENTIFICATION DATA

Photo No. _____
Filed At. _____
Object Ident. _____
Ident. By _____
Signature

DESCRIBE CORNER LOCATION RELATIVE TO NEAR-BY FEATURES, ALSO HOW TO REACH CORNER

Take Hwy. 58 from Jct. 58 & 97 northerly to mile post 82. Take road 254 + 1.7 mile to emigrant crossing. Take road 2521 South + 2.8 miles to section line crossing. Corner is + 200 feet East.

PLANE COORDINATE POSITION DATA

State _____ Zone _____
X _____
Y _____
Estab. By _____
Agency

Signature James R. Tye Title Surveyor Division Sun Country Eng. & Surv. Bend Off. Headquarters _____ Date 7100-52-(3/68)
4 - 78

CORNER RECORD (PERPETUATION)

MONUMENT: DESCRIBE NEW MONUMENT SET, OR WORK DONE TO PRESERVE EXISTING MONUMENT

Set 2½" galvanized iron pipe and 2½" brass cap.

T 26 S
R 7 E R 8 E
S 12 | S 7
S 13 | S 18
1978
L.S. 1104

9

ACCESSORIES : DESCRIBE NEW BT'S WITNESS OBJECTS ETC. ESTABLISHED, OR WORK DONE TO PRESERVE EXISTING EVIDENCE

Scribed four bearing trees:

A 10" D.B.H. Ponderosa pine bears S 62° W 86.28'

A 12" D.B.H. Ponderosa pine bears N 39° 10' W 68.50'

A 9" D.B.H. Lodgepole pine bears N 26° 50' E 41.40'

A 12" D.B.H. Lodgepole pine bears S 46° 40' E 86.36'

10

Work Done By James R. Tye Title Surveyor Date 4-78 State Registration No. L.S. 1104
or Agency

Certified Cor. Record Prepared? Yes (NO) Filed At: _____ Date _____

11

REMARKS

(8/87) Walt Miller - PLS 2111 - Revisited site
Refer to plat #000749

Witness to corner:

Michael J. Yardley

Index File No.

T. 26 S

R. 8 E

M. W. M.

Tract or Surv. No. 00686 N

Cor. J1

12

13

Index
File No. 0359

CORNER RECORD (SEARCH)
(Ref. FSM 7151.4)

Tract or
Survey No. 006686N Cor. No. J 3

T 26 S R. 8 E R.D. Crescent County Klamath
Merid. Willamette N.F. Deschutes State Oregon S/4 Sec. 7

CORNER DIAGRAM

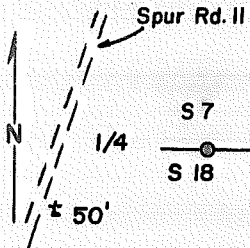

DESCRIBE CORNER MONUMENT FOUND

No original evidence found.

DESCRIBE BEARING TREES OR OTHER OFFICIAL ACCESSORIES FOUND

No original bearing trees found.

PHOTO IDENTIFICATION DATA

Photo No. _____
Filed At. _____
Object Ident. _____
Ident. By _____
Signature

DESCRIBE CORNER LOCATION RELATIVE TO NEAR-BY FEATURES, ALSO HOW TO REACH CORNER

Take Hwy. 58 northerly from Jct. 58 & 97 to approx. mile post 83.27. Take spur road 11 South ± 3.0 miles. Corner is ± 50' East.

PLANE COORDINATE POSITION DATA

State _____ Zone _____
X _____
Y _____
Estob. By _____
Agency

Signature James R. Tye Title Surveyor Division Bend Office Headquarters Sun Country Eng. & Surv. Date 4-78 7100-52-(3/68)

CORNER RECORD (PERPETUATION)

MONUMENT : DESCRIBE NEW MONUMENT SET, OR WORK DONE TO PRESERVE EXISTING MONUMENT

Set 2½" galvani ed iron pipe and brass cap.

T 26 S R 8 E
 ¼ S 7
 S 18
 1978
 L.S. 1104

9

ACCESSORIES : DESCRIBE NEW BT's WITNESS OBJECTS ETC. ESTABLISHED, OR WORK DONE TO PRESERVE EXISTING EVIDENCE

Scribed two bearing trees:

An 8" D.B.H. Lodgepole pine bears S 06° 50' East 28.56'
 An 8" D.B.H. Lodgepole pine bears N 08° 10' West 56.34'

10

Work Done By James R. Tye Title Surveyor Date 4-78 State Registration No. L.S. 1104
 or Agency _____

Certified Cor. Record Prepared ? Yes No Filed At: _____ Date _____

11

REMARKS

Revisited by Walt Miller PLS 2111 (8/87)
 Refer to plat N^o 000749

Witness to corner:

Michael J. Yardley

Index File No. T. 26S R. 8E M. W.M. Tract or Surv. No. 00686N Cor. J3

12

13

Index
File No. _____

CORNER RECORD (SEARCH)

(Ref. FSM 7151.4)

Tract or Survey No. 006686N Cor. No. J 5

T 26 S R. 8 E R.D. Crescent County Klamath
Merid Willamette N.F. Deschutes State Oregon

CORNER DIAGRAM

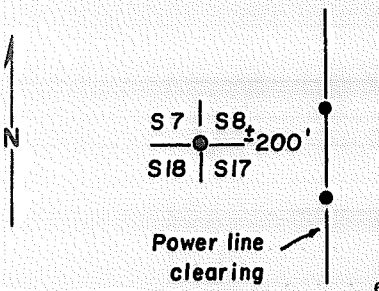

DESCRIBE CORNER MONUMENT FOUND

No original evidence found.

2

DESCRIBE BEARING TREES OR OTHER OFFICIAL ACCESSORIES FOUND

No original bearing trees found.

6

PHOTO IDENTIFICATION DATA

Photo No. _____
Filed At. _____
Object Ident. _____
Ident. By _____
Signature

DESCRIBE CORNER LOCATION RELATIVE TO NEAR-BY FEATURES, ALSO HOW TO REACH CORNER

Take Hwy. 58 northerly from Jct. 58 & 97 to approx. mile post 83.27. Take spur road 11 + 1.8 miles. Take power line clearing South + 1 mile. Corner is + 200' West of clearing.

3

PLANE COORDINATE POSITION DATA

State _____ Zone _____
X _____
Y _____
Estab. By _____
Agency

8

James R. Tye
Signature

Title
Surveyor

Division
Bend Off.

Headquarters
Sun Country Eng. & Surv.

Date
4-78

7100-52-(3/68)

4

5

CORNER RECORD (PERPETUATION)

MONUMENT : DESCRIBE NEW MONUMENT SET, OR WORK DONE TO PRESERVE EXISTING MONUMENT

Set 2½" galvanized iron pipe and 2½" brass cap.

T 26 S	R 8 E
S 7	S 8
S 18	S 17
1978	
L.S. 1104	

9

ACCESSORIES : DESCRIBE NEW BT'S WITNESS OBJECTS ETC. ESTABLISHED, OR WORK DONE TO PRESERVE EXISTING EVIDENCE

Scribed four bearing trees:

- A 9" D.B.H. Lodgepole pine bears S 56° 40' W 62.18'
- An 8" D.B.H. Lodgepole pine bears S 45° 20' E 125.12'
- A 9" D.B.H. Lodgepole pine bears N 46° 50' E 61.84'
- A 6" D.B.H. lodgepole pine bears N 52° 20' W 32.72'

10

Work Done By James R. Tye Title Surveyor Date 4-78 State Registration No. L.S. 1104
or Agency

Certified Cor. Record Prepared ? Yes No Filed At: _____ Date _____ 11

REMARKS

Witness to corner:

Michael J. Yardley

Index File No.

T. 26 S R. 8 E

M. W. M.

Tract or Surv. No. 00686 N

Cor. J 5

12

13

Index
File No. _____

CORNER RECORD (SEARCH)
(Ref. FSM 7151.4)

Tract or
Survey No. 006686N Cor. No. J 7

T 26 S R. 8 E R.D. Crescent County Klamath
Merid. Willamette N.F. Deschutes State Oregon

CORNER DIAGRAM

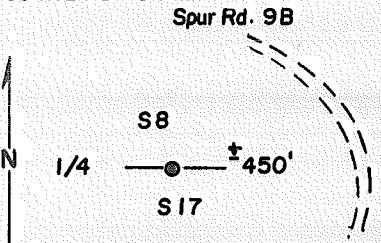

DESCRIBE CORNER MONUMENT FOUND

No original evidence found.

DESCRIBE BEARING TREES OR OTHER OFFICIAL ACCESSORIES FOUND

No original bearing trees found.

PHOTO IDENTIFICATION DATA

Photo No. _____
Filed At. _____
Object Ident. _____
Ident. By _____
Signature

DESCRIBE CORNER LOCATION RELATIVE TO NEAR-BY FEATURES, ALSO HOW TO REACH CORNER

Take Hwy. 58 northerly from Jct. 58 & 97 to approx. mile post 85.
Take spur road 1 south ± 1.6 miles to SE corner Sec. 8. Take spur road 9B which is ± 500' south of said corner. Take 9B Northwesterly ± 1/2 mile to section line sign board. Corner is ± 450' west.

PLANE COORDINATE POSITION DATA

State _____ Zone _____
X _____
Y _____
Estab. By _____
Agency

Signature
James R. Tye

Title **Surveyor** Division **Bend Off.** Headquarters **Sun Country Eng. & Surv.** Date **4-78** 7100-52-(3/68)

CORNER RECORD (PERPETUATION)

MONUMENT: DESCRIBE NEW MONUMENT SET, OR WORK DONE TO PRESERVE EXISTING MONUMENT

T 26 S R 8 E

Set 2½" galvanized iron pipe and 2½" brass cap.

¼ $\frac{S\ 8}{S\ 17}$

1978

I. S. 1104

9

ACCESSORIES : DESCRIBE NEW BT's WITNESS OBJECTS ETC. ESTABLISHED, OR WORK DONE TO PRESERVE EXISTING EVIDENCE

Scribed two bearing trees:

An 8" D.B.H. Lodgepole pine bears S 76° 10' W 49.16'

A 7" D.B.H. Lodgepole pine bears N 14° 10' E 51.76'

A 10" D.B.H. Lodgepole pine bears S 43° E 52.58'

10

Work Done By James R. Tye Title Surveyor Date 4-78 State Registration No. I. S. 1104
or Agency

Certified Cor. Record Prepared ? Yes (No) Filed At: _____ Date _____

11

REMARKS

Witness to corner:

Michael J. Yardley

Index File No. T. 26 S R. 8 E M. W. M. Tract or Surv. No. 00686 N Cor. J7

12

13

Index File No. 0959

CORNER RECORD (SEARCH). Contract or Survey No.
(Ref. FSM 7151.4)

Cor. No. J-09

T 26 S. R. 8 E. R.D. Crescent County Klamath SE Cor. of

Merid. Willamette N.F. Deschutes State Oregon Section 8

CORNER DIAGRAM per legend

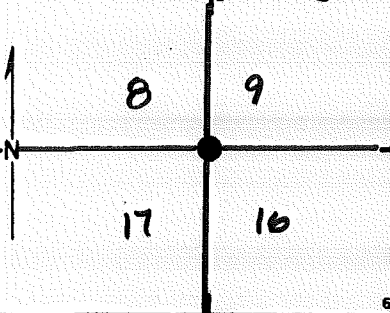

DESCRIBE CORNER MONUMENT FOUND

BCSP

DESCRIBE BEARING TREES OR OTHER OFFICIAL ACCESSORIES FOUND

9" h. Pine - N 34°E @ 90° T 26 S R 8 E S 9 BT

28" P. Pine - S 40°E @ 39° BLAZE HEALED OVER.

10" L. Pine - S 50°W @ 100° T 26 S R 8 E S 17 BT

18" P. Pine - N 60°W @ 62° T 26 S R 8 E S 8 BT

PHOTO IDENTIFICATION DATA

Photo No.

Filed At.

Object Ident.

Ident. By

Signature

DESCRIBE CORNER LOCATION RELATIVE TO NEAR-BY FEATURES, ALSO HOW TO REACH CORNER

CORNER LEGEND:

FS or Unverified
Contr. Other

○ ◇ Searched For/Not Found

⊗ ⊠ Evidence Found/Accept.

● ◆ Permanent Mon. Set/Fd.

Searched By: SC/GS Title ST Division CS Headquarters SD Date 6-5-84

CORNER RECORD (PERPETUATION)

MONUMENT: DESCRIBE NEW MONUMENT SET, OR WORK DONE TO PRESERVE EXISTING MONUMENT

MONUMENT STAMPED

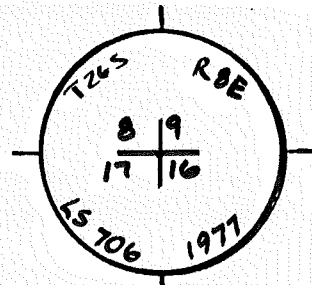

9

ACCESSORIES : DESCRIBE NEW BT'S WITNESS OBJECTS ETC. ESTABLISHED, OR WORK DONE TO PRESERVE EXISTING EVIDENCE

10

Work Done By _____ Title _____ Date _____ State Registration No. _____
Plat or _____ or Agency _____
Certified Cor. Record Prepared? Yes No Filed At: _____ Co. Surveyor's Office Date _____

11

History of Surveys, G.L.O., etc. _____

12

Index
 File No. 1159 CORNER RECORD (SEARCH) Contract or Survey No. J-11
 (Ref. FSM 7151.4)
 T 26 S. R. 8 E. R.D. Crescent County Klamath S/4 Cor. of
 Merid. Willamette N.F. Deschutes State Oregon Section 9

CORNER DIAGRAM, per legend

DESCRIBE CORNER MONUMENT FOUND

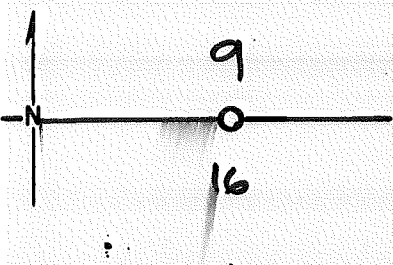

SFNF

DESCRIBE BEARING TREES OR OTHER OFFICIAL ACCESSORIES FOUND

SFNF

PHOTO IDENTIFICATION DATA

LOCATION FALLS IN EDGE OF CLEAR CUT.

Photo No. _____
 Filed At. _____
 Object Ident. _____
 Ident. By _____
 Signature

DESCRIBE CORNER LOCATION RELATIVE TO NEAR-BY FEATURES, ALSO HOW TO REACH CORNER

CORNER LEGEND:
 FS or Unverified
 Contr. Other
 Searched For/Not Found
 Evidence Found/Accept.
 Permanent Mon. Set/Fd.

Searched By: SC/GS Title ST Division CS Headquarters SO Date 6-6-84

CORNER RECORD (PERPETUATION)

MONUMENT: DESCRIBE NEW MONUMENT SET, OR WORK DONE TO PRESERVE EXISTING MONUMENT

Four horizontal lines for describing the monument.

MONUMENT STAMPED

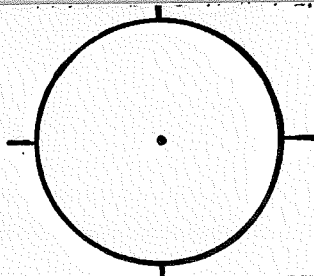

ACCESSORIES: DESCRIBE NEW BT'S WITNESS OBJECTS ETC. ESTABLISHED, OR WORK DONE TO PRESERVE EXISTING EVIDENCE

Five horizontal lines for describing accessories.

Work Done By _____ Title _____ Date _____ State Registration No. or Agency _____
Plat of Cor. Record Prepared? Yes No Filed At: _____ Co. Surveyor's Office Date _____

History of Surveys, G.L.O., etc.

Four horizontal lines for recording the history of surveys.

Index File No.

1159

T. S., R. E., W.M.

26

8

Contract or Surv. No.

Cor.

J-11

Index File No. 1359

CORNER RECORD (SEARCH) Contract or Survey No.
 (Ref. FSM 7151.4)

Cor. No. J-13

T 26 S. R. 8 E. R.D. Crescent

County Klamath

SE Cor. of

Merid. Willamette

N.F. Deschutes

State Oregon

Section 9

CORNER DIAGRAM per legend

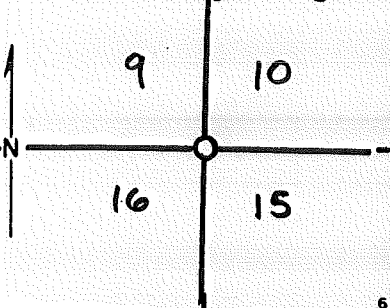

DESCRIBE CORNER MONUMENT FOUND

SFNF

DESCRIBE BEARING TREES OR OTHER OFFICIAL ACCESSORIES FOUND

SFNF

6 LOTS OF WOODCUTTERS. MOST OLD TREES ARE BURNED.

PHOTO IDENTIFICATION DATA

Photo No.
 Filed At.
 Object Ident.
 Ident. By
 Signature

DESCRIBE CORNER LOCATION RELATIVE TO NEAR-BY FEATURES, ALSO HOW TO REACH CORNER

CORNER LEGEND:

- FS or Contr. Unverified Other
- ◇ Searched For/Not Found
- ⊗ ⊗ Evidence Found/Accept.
- ◆ Permanent Mon. Set/Id.

Searched By:

SC/68

Title

ST

Division

CS

Headquarters

SO

Date

6-5-84

CORNER RECORD (PERPETUATION)

MONUMENT STAMPED

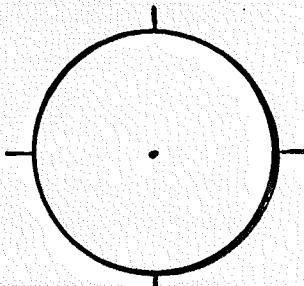

MONUMENT: DESCRIBE NEW MONUMENT SET, OR WORK DONE TO PRESERVE EXISTING MONUMENT

Three horizontal lines for describing the monument.

ACCESSORIES : DESCRIBE NEW BT'S WITNESS OBJECTS ETC. ESTABLISHED, OR WORK DONE TO PRESERVE EXISTING EVIDENCE

Five horizontal lines for describing accessories.

Work Done By _____ Title _____ Date _____ State Registration No. _____
 or Agency _____

Plat or Certified Cor. Record Prepared? Yes No Filed At: _____ Co. Surveyor's Office Date _____

History of Surveys, G.L.O., etc.

Four horizontal lines for the history of surveys.

Index File No. 1359 T. 26 S., R. 8 E., W.M.

Contract or Surv. No.

Cor. J-13

Index
File No. _____

CORNER RECORD (SEARCH)

(Ref. FSM 7151.4)

Tract or Survey No. 006686N Cor. No. L 5

T 26 S R. 8 E R.D. Crescent County Klamath
Merid. Willamette N.F. Deschutes State Oregon

CORNER DIAGRAM

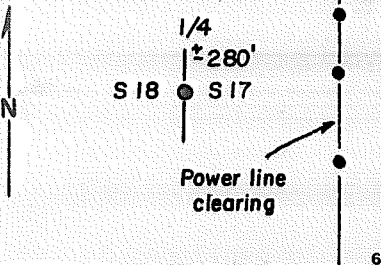

DESCRIBE CORNER MONUMENT FOUND

No original evidence found. 2

DESCRIBE BEARING TREES OR OTHER OFFICIAL ACCESSORIES FOUND

No original bearing trees found. 3

PHOTO IDENTIFICATION DATA

Photo No. _____
Filed At. _____
Object Ident. _____
Ident. By _____
Signature 7

DESCRIBE CORNER LOCATION RELATIVE TO NEAR-BY FEATURES, ALSO HOW TO REACH CORNER

Take Hwy. 58 northerly from Jct. 58 & 97 to approx. mile post 83.27.
Take spur road 11 South + 1.8 miles. Take power line clearing South + 1.5 miles. Corner is + 280' West of power line clearing.

PLANE COORDINATE POSITION DATA

State _____ Zone _____
X _____
Y _____
Estob. By _____
Agency 8

Signature James R. Tye Title Surveyor Division Bend Off. Headquarters Sun Country Eng. & Surv. Date 4-78 7100-52-(3/68) 5

CORNER RECORD (PERPETUATION)

MONUMENT: DESCRIBE NEW MONUMENT SET, OR WORK DONE TO PRESERVE EXISTING MONUMENT

Set 2½" galvanized iron pipe and 2½" brass cap.

T 26 S R 8 E
 |
 S 18 S 17
 1978
 L.S. 1104

9

ACCESSORIES : DESCRIBE NEW BT'S WITNESS OBJECTS ETC. ESTABLISHED, OR WORK DONE TO PRESERVE EXISTING EVIDENCE

Secribed two bearing trees:

An 11" D.B.H. Lodgepole pine bears S 60° 10' West 94.62'

A 6" D.B.H. Lodgepole pine bears N 60° 10' East 72.00'

10

Work Done By James R. Tye Title Surveyor Date 4-78 State Registration No. L.S. 1104
 or Agency

Certified Cor. Record Prepared ? Yes No Filed At: _____ Date _____

11

REMARKS

Witness to corner:

Michael J. Yardley

Index File No. T. 26 S R. 8 E M. W. M. Tract or Surv. No. 00686 N Cor. L 5

12

13

Index _____ Contract or
 File No. 1361 CORNER RECORD (SEARCH) Survey No. L-13
 (Ref. FSM 7151.4)
 T 26 S. R. 8 E. R.D. Crescent County Klamath W/4 Cor. of
 Merid. Willamette N.F. Deschutes State Oregon Section 15

CORNER DIAGRAM per legend

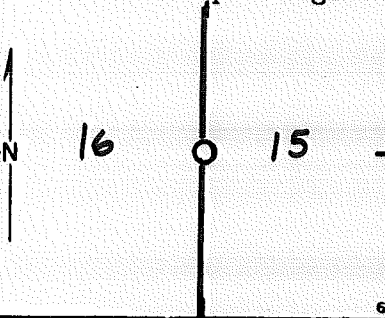

DESCRIBE CORNER MONUMENT FOUND

SFNF

DESCRIBE BEARING TREES OR OTHER OFFICIAL ACCESSORIES FOUND

SFNF
LOTS OF WOODCUTTERS

PHOTO IDENTIFICATION DATA

Photo No. _____
 Filed At. _____
 Object Ident. _____
 Ident. By _____
 Signature _____

DESCRIBE CORNER LOCATION RELATIVE TO NEAR-BY FEATURES, ALSO HOW TO REACH CORNER

CORNER LEGEND:

- | | | |
|--------|------------|------------------------|
| FS or | Unverified | |
| Contr. | Other | |
| ○ | ◇ | Searched For/Not Found |
| ⊗ | ⊗ | Evidence Found/Accept. |
| ● | ◆ | Permanent Mon. Set/Fd. |

Searched By: _____ Title _____ Division _____ Headquarters _____ Date _____

SL/GS ST CS SO 6-5-84

CORNER RECORD (PERPETUATION)

MONUMENT: DESCRIBE NEW MONUMENT SET, OR WORK DONE TO PRESERVE EXISTING MONUMENT

MONUMENT STAMPED

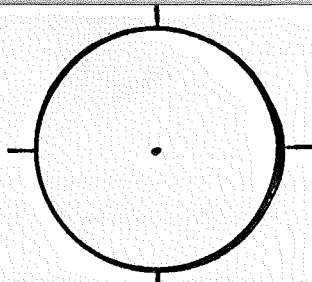

9

ACCESSORIES : DESCRIBE NEW BT'S WITNESS OBJECTS ETC. ESTABLISHED, OR WORK DONE TO PRESERVE EXISTING EVIDENCE

10

Work Done By _____ Title _____ Date _____ State Registration No. or Agency _____
Plat or Certified Cor. Record Prepared? Yes No Filed At: _____ Co. Surveyor's Office Date _____

11

History
of
Surveys,
G.L.O.,
etc.

12

Index File No. 1361

T. 26 S., R. 8 E., W.M.

Contract or Surv. No.

Cor. L-13 13

Index
 File No. N-1
 T 26S R. 8E
 Merid. Will

CORNER RECORD (SEARCH)

(Ref. FSM 7151.4)

R.D. Crescent County Klamath
 N.F. Deschutes State Oregon

Tract or Survey No. _____
 Cor. No. N-01

Sec. 600

CORNER DIAGRAM

DESCRIBE CORNER MONUMENT FOUND

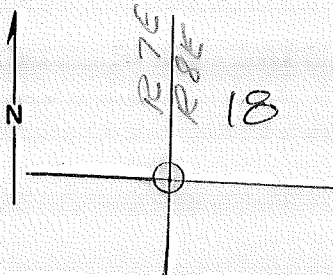

SEE N-25, T26S, R7E

DESCRIBE BEARING TREES OR OTHER OFFICIAL ACCESSORIES FOUND

SFNF

PHOTO IDENTIFICATION DATA

Photo No. _____
 Filed At. _____
 Object Ident. _____
 Ident. By _____
Signature

DESCRIBE CORNER LOCATION RELATIVE TO NEAR-BY FEATURES, ALSO HOW TO REACH CORNER

PLANE COORDINATE POSITION DATA

State _____ Zone _____
 X _____
 Y _____
 Estab. By _____
Agency

Signature

Title

Division

Headquarters

Date

7100-52 (3/68)

CORNER RECORD (PERPETUATION)

MONUMENT : DESCRIBE NEW MONUMENT SET, OR WORK DONE TO PRESERVE EXISTING MONUMENT

9

ACCESSORIES : DESCRIBE NEW BT'S WITNESS OBJECTS ETC. ESTABLISHED, OR WORK DONE TO PRESERVE EXISTING EVIDENCE

10

Work Done By _____ Title _____ Date _____ State Registration No. or Agency _____

Certified Cor. Record Prepared ? Yes No Filed At: _____ Date _____

11

REMARKS

Index File No.

T.

R.

M.

Tract or Surv. No.

Cor. *N-01* 12
13

Index
File No. 0563
T 26 S. R. 8 E. R.D. Crescent
Merid. Willamette N.F. Deschutes

CORNER RECORD (SEARCH) Contract or
(Ref. FSM 7151.4) Survey No. _____
County Klamath State Oregon

Cor. No. N-05
Cor. of SE
Section 18

CORNER DIAGRAM per legend

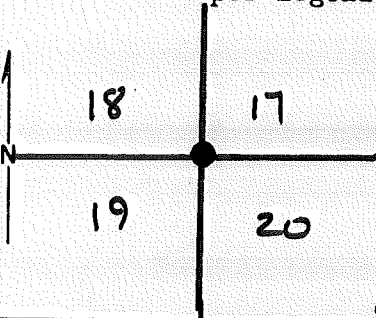

DESCRIBE CORNER MONUMENT FOUND

BCSP RSG. 4" ABOVE GROUND.

DESCRIBE BEARING TREES OR OTHER OFFICIAL ACCESSORIES FOUND

21" L. Pine N73°W @ 53°
10" " " N27°E @ 18^S HEALED OVER
17" " " S60°E @ 61^S " "
9" " " S44°W @ 92° T265 R8E S19 BT

PHOTO IDENTIFICATION DATA

Photo No. _____
Filed At. _____
Object Ident. _____
Ident. By _____
Signature

DESCRIBE CORNER LOCATION RELATIVE TO NEAR-BY FEATURES, ALSO HOW TO REACH CORNER

350' West of Powerline Road w/location
~~tags~~ TAGS.

CORNER LEGEND:

- FS or Unverified
- Contr. Other
- ◇ Searched For/Not Found
- ⊗ ⊗ Evidence Found/Accept.
- ◆ Permanent Mon. Set/Fd.

Searched By: _____ Title _____ Division _____ Headquarters _____ Date _____

SC/GS ST ES SO 6-6-84

CORNER RECORD (PERPETUATION)

MONUMENT: DESCRIBE NEW MONUMENT SET, OR WORK DONE TO PRESERVE EXISTING MONUMENT

MONUMENT STAMPED

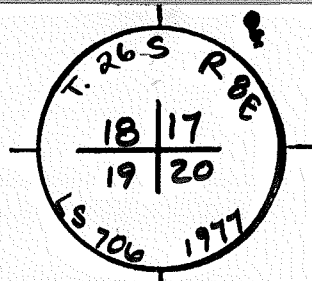

ACCESSORIES : DESCRIBE NEW BT'S WITNESS OBJECTS ETC. ESTABLISHED, OR WORK DONE TO PRESERVE EXISTING EVIDENCE

Work Done By _____ Title _____ Date _____ State Registration No. or Agency _____
Plat or Certified Cor. Record Prepared? Yes No Filed At. Co. Surveyor's Office Date

History
of
Surveys,
G.L.O.,
etc.

Index File No. 0563

T. 26 S., R. 8 E., W.M.

Contract or Surv. No.

Cor. N-05

Index
File No. 0763

CORNER RECORD (SEARCH)
(Ref. FSM 7151.4)

Contract or
Survey No. N-07

T 26 S. R. 8 E. R.D. Crescent County Klamath 5/4 Cor. of

Merid. Willamette N.F. Deschutes State Oregon Section 17

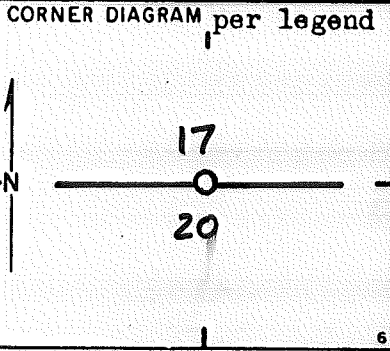

DESCRIBE CORNER MONUMENT FOUND

SFNF

DESCRIBE BEARING TREES OR OTHER OFFICIAL ACCESSORIES FOUND

SFNF

FALLS REAL CLOSE TO ROAD. HEAVY LOGGING
ACTIVITY.

PHOTO IDENTIFICATION DATA
Photo No. _____
Filed At. _____
Object Ident. _____
Ident. By _____
Signature

DESCRIBE CORNER LOCATION RELATIVE TO NEAR-BY FEATURES, ALSO HOW TO REACH CORNER

CORNER LEGEND:

FS or Contr.	Unverified Other	
○	◇	Searched For/Not Found
⊗	⊗	Evidence Found/Accept.
●	◆	Permanent Mon. Set/Fd.

Searched By: SC/GS Title ST Division CS Headquarters SO Date 6-6-84

CORNER RECORD (PERPETUATION)

MONUMENTS DESCRIBE NEW MONUMENT SET, OR WORK DONE TO PRESERVE EXISTING MONUMENT

MONUMENT STAMPED

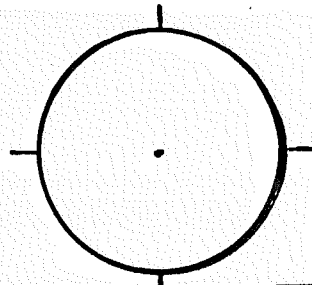

ACCESSORIES : DESCRIBE NEW BT'S WITNESS OBJECTS ETC. ESTABLISHED, OR WORK DONE TO PRESERVE EXISTING EVIDENCE

Work Done By _____ Title _____ Date _____ State Registration No. or Agency _____
Plat or Certified Cor. Record Prepared? Yes No Filed At. Co. Surveyor's Office Date

History of Surveys, G.L.O., etc.

Post
9" Pine N50°W @ 99
10" " S10°W @ 66

Index File No. 0763 T. 26 S., R. 8 E., W.M.

Contract or Surv. No.

Cor. N-07 13

Index File No. 0963 CORNER RECORD (SEARCH) Contract or Survey No. N-09
 (Ref. FSM 7151.4)
 T 26 S. R. 8 E. R.D. Crescent County Klamath SE Cor. of
 Merid. Willamette N.F. Deschutes State Oregon Section 17

CORNER DIAGRAM, per Legend

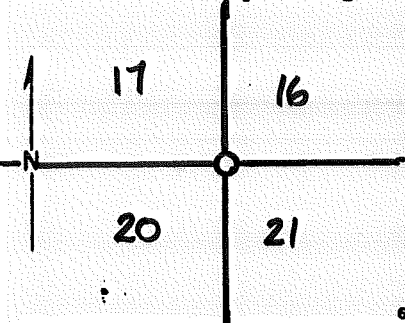

DESCRIBE CORNER MONUMENT FOUND

SENF

DESCRIBE BEARING TREES OR OTHER OFFICIAL ACCESSORIES FOUND

SENF

PHOTO IDENTIFICATION DATA

Photo No. _____
 Filed At. _____
 Object Ident. _____
 Ident. By _____
 Signature _____

FALLS IN PIPE-LINE CLEARING

DESCRIBE CORNER LOCATION RELATIVE TO NEAR-BY FEATURES, ALSO HOW TO REACH CORNER

CORNER LEGEND:

- FS or Unverified
- Contr. Other
- Searched For/Not Found
- ◇ Searched For/Not Found
- ⊗ Evidence Found/Accept.
- ⊗ Evidence Found/Accept.
- Permanent Mon. Set/Fd.
- ◆ Permanent Mon. Set/Fd.

Searched By: SC/GS Title ST Division CS Headquarters SO Date 6-6-84

CORNER RECORD (PERPETUATION)

MONUMENT: DESCRIBE NEW MONUMENT SET, OR WORK DONE TO PRESERVE EXISTING MONUMENT

MONUMENT STAMPED

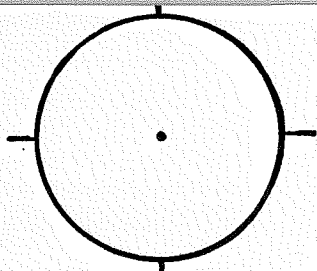

9

ACCESSORIES: DESCRIBE NEW BT'S WITNESS OBJECTS ETC. ESTABLISHED, OR WORK DONE TO PRESERVE EXISTING EVIDENCE

10

Work Done By _____ Title _____ Date _____ State Registration No. or Agency _____

~~Plat~~ ~~of~~ Cor. Record Prepared? Yes No Filed At: _____ Co. Surveyor's Office Date _____

11

History _____
of _____
Surveys, _____
G.L.O., _____
etc. _____

12

Index File No. _____ T. _____ S., R. _____ E., W.M. _____ Contract or Surv. No. _____ Cor. _____

0963 26 8

N-09

13

Index File No. 1163 CORNER RECORD (SEARCH) (Ref. FSM 7151.4) Contract or Survey No. _____ Cor. No. N-11
 T 26 S. R. 8 E. R.D. Crescent County Klamath S/4 Cor. of
 Merid. Willamette N.F. Deschutes State Oregon Section 16

CORNER DIAGRAM, per legend

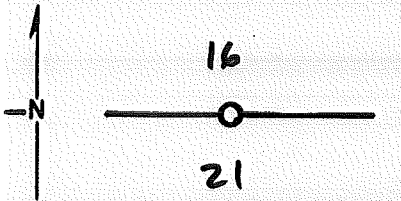

DESCRIBE CORNER MONUMENT FOUND

SFNF

DESCRIBE BEARING TREES OR OTHER OFFICIAL ACCESSORIES FOUND

SFNF

PHOTO IDENTIFICATION DATA

Photo No. _____
 Filed At. _____
 Object Ident. _____
 Ident. By _____
 Signature _____

FALLS IN PIPE-LINE CLEARING

DESCRIBE CORNER LOCATION RELATIVE TO NEAR-BY FEATURES, ALSO HOW TO REACH CORNER

CORNER LEGEND:

- FS or Unverified
- Contr. Other
- ◊ Searched For/Not Found
- ⊗ ⊗ Evidence Found/Accept.
- ◆ Permanent Mon. Set/Fd.

Searched By: SC/CS Title ST Division CS Headquarters SO Date 6-6-84

CORNER RECORD (PERPETUATION)

MONUMENT: DESCRIBE NEW MONUMENT SET, OR WORK DONE TO PRESERVE EXISTING MONUMENT

MONUMENT STAMPED

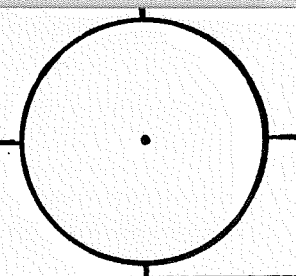

ACCESSORIES: DESCRIBE NEW BT'S WITNESS OBJECTS ETC. ESTABLISHED, OR WORK DONE TO PRESERVE EXISTING EVIDENCE

Work Done By _____ Title _____ Date _____ State Registration No. or Agency _____

Plat or Cor. Record Prepared? Yes No Filed At: _____ Co. Surveyor's Office Date _____

History of Surveys, G.L.O., etc.

Index File No. 1163 T. 26 S., R. 8 E., W.M. Contract or Surv. No. Cor. N-11

Index
 File No. 1363 CORNER RECORD (SEARCH) Contract or
 (Ref. FSM 7151.4) Survey No. Cor. No. N-13
 T 26 S. R. 8 E. R.D. CRESCENT County KLAMATH SW Cor. of
 Merid. Willamette N.F. Deschutes State Oregon Section 15

CORNER DIAGRAM per legend

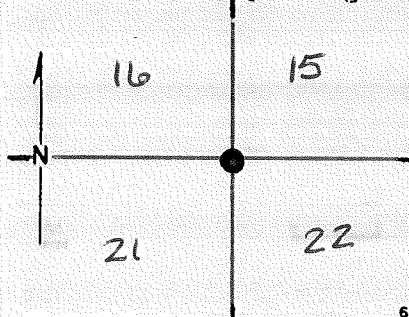

DESCRIBE CORNER MONUMENT FOUND

SELF

DESCRIBE BEARING TREES OR OTHER OFFICIAL ACCESSORIES FOUND

10" DEAD & DOWN L.P.P. SCRIBED "T26 S 52.1 BT" BEARS S 45° W @
3.3 FT. TO ITS ROOT HOLE

PHOTO IDENTIFICATION DATA

Photo No.
 Filed At.
 Object Ident.
 Ident. By
 Signature

BADLY DELAYED WOOD IN S.E. LOCATION - REMAINS OF STUMP
WITH NO VISIBLE SCRIBING - ONLY AXE MARKS

DESCRIBE CORNER LOCATION RELATIVE TO NEAR-BY FEATURES, ALSO HOW TO REACH CORNER

CORNER LEGEND:

- | | | |
|--------|------------|------------------------|
| FS or | Unverified | |
| Contr. | Other | |
| ○ | ◇ | Searched For/Not Found |
| ⊗ | ⊗ | Evidence Found/Accept. |
| ● | ◆ | Permanent Mon. Set/Fd. |

Searched By: W. MILLER Title L.S Division ENG. Headquarters S.O. Date 5/18/85

CORNER RECORD (PERPETUATION)

MONUMENT. DESCRIBE NEW MONUMENT SET, OR WORK DONE TO PRESERVE EXISTING MONUMENT

SET 2 1/2" X 30" ~~R.S.P.~~ S.P. WITH 3 1/4" B.C. RISING 3"

MONUMENT STAMPE

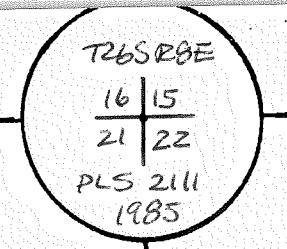

ACCESSORIES DESCRIBE NEW BT'S WITNESS OBJECTS ETC. ESTABLISHED, OR WORK DONE TO PRESERVE EXISTING EVIDENCE

- 1) 6" L.P.P. BEARS N 31 1/4° E - 45.61 FT. TO A 60-PENNY SPIKE IN NW. BASE - MKD T26SR08E S15 BT
- 2) 8" " " S 71° E - 38.97" " " " " " " S. " - " T26SR08E S22 BT
- 3) 5" " " S 49 1/2° W - 10.39 " " " " " " " NW. " - MKD 'X' BT
- 4) 5" " " N 70 1/2° W - 30.01 " " " " " " " WNE " - " 'X' BT

Work Done By W. MILLER Title L.S. Date 5/13/85 State Registration No. # 2111
or Agency

Flat or Record Prepared? Yes No Filed At KLAMATH Co. Surveyor's Office Date 5/17/85

History of Surveys, G.L.O., etc. POST
3" PINE - N 45° W @ 50 LRS.
3" " - N 25° E @ 25 "
3" " - S 80° E @ 15 "
4" " - S 45° W @ 5 "

Index File No. T. S., R. E., W.M. Contract or Surv. No. Cor. N-13

Index File No. 1365

CORNER RECORD (SEARCH) Contract or Survey No. (Ref. FSM 7151.4)

Cor. No. P-13

T 26 S. R. 8 E. R.D. Crescent County Klamath E/4 Cor. of Merid. Willamette N.F. Deschutes State Oregon Section 21

CORNER DIAGRAM per legend

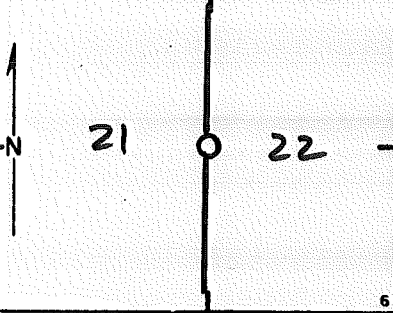

DESCRIBE CORNER MONUMENT FOUND

SFNF

DESCRIBE BEARING TREES OR OTHER OFFICIAL ACCESSORIES FOUND

SFNF - AREA HAS BEEN BURNED OVER...

PHOTO IDENTIFICATION DATA

Photo No. _____
Filed At. _____
Object Ident. _____
Ident. By _____
Signature

DESCRIBE CORNER LOCATION RELATIVE TO NEAR-BY FEATURES, ALSO HOW TO REACH CORNER

75' EAST OF R.R.

CORNER LEGEND:

FS or Contr.	Unverified Other	
<input type="radio"/>	<input type="checkbox"/>	Searched For/Not Found
<input checked="" type="checkbox"/>	<input checked="" type="checkbox"/>	Evidence Found/Accept.
<input type="checkbox"/>	<input type="checkbox"/>	Permanent Mon. Set/Fd.

Searched By: SC/CS Title ST Division CS Headquarters SO Date 6-5-84

CORNER RECORD (PERPETUATION)

MONUMENTS : DESCRIBE NEW MONUMENT SET, OR WORK DONE TO PRESERVE EXISTING MONUMENT

MONUMENT STAMPED

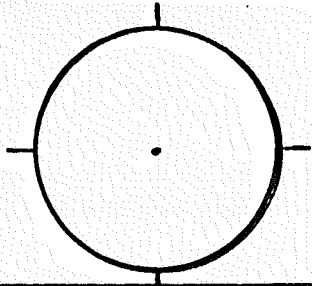

9

ACCESSORIES : DESCRIBE NEW BT'S WITNESS OBJECTS ETC. ESTABLISHED, OR WORK DONE TO PRESERVE EXISTING EVIDENCE

10

Work Done By _____ Title _____ Date _____ State Registration No. or Agency _____
Plat or Certified Cor. Record Prepared ? Yes No Filed At: _____ Co. Surveyor's Office Date _____

11

History of Surveys, G.L.O., etc. _____

12

13

CORNER RECORD (SEARCH)

(Ref. FSM 7151.4)

Index
File No. R-25/1

Tract or Survey No. _____
Cor. No. R-01

T 26 S R. 8E R.D. Crescent County Klamath Sec Cor

Merid. Will N.F. Deschutes State Oregon

CORNER DIAGRAM

DESCRIBE CORNER MONUMENT FOUND

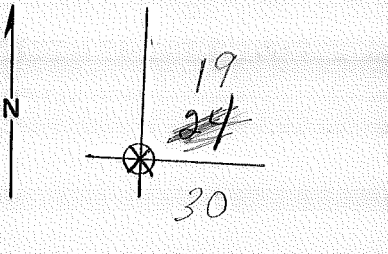

-R-25
SEE - A-25, T26S, R7E

DESCRIBE BEARING TREES OR OTHER OFFICIAL ACCESSORIES FOUND

E.V. FD

PHOTO IDENTIFICATION DATA

Photo No. _____
Filed At. _____
Object Ident. _____
Ident. By _____
Signature

DESCRIBE CORNER LOCATION RELATIVE TO NEAR-BY FEATURES, ALSO HOW TO REACH CORNER

PLANE COORDINATE POSITION DATA

State _____ Zone _____
X _____
Y _____
Estab. By _____
Agency

Signature _____ Title _____ Division _____ Headquarters _____ Date _____

CORNER RECORD (PERPETUATION)

MONUMENT : DESCRIBE NEW MONUMENT SET, OR WORK DONE TO PRESERVE EXISTING MONUMENT

9

ACCESSORIES : DESCRIBE NEW BT's WITNESS OBJECTS ETC. ESTABLISHED, OR WORK DONE TO PRESERVE EXISTING EVIDENCE

10

Work Done By _____ Title _____ Date _____ State Registration No. or Agency _____

Certified Cor. Record Prepared ? Yes No Filed At: _____ Date _____

11

REMARKS

12

Index File No.

T.

R.

M.

Tract or Surv. No.

Cor.

R-01

13

Index File No. 0567
T 265 R. 8E
Merid. Willamette

CORNER RECORD (SEARCH)
(Ref. FSM 7151.4)

Tract or Survey No. _____
Cor. No. R-05
SE COR. SEC. 19
NW COR. SEC. 29

R.D. Crescent County Klamath
N.F. Deschutes State Oregon

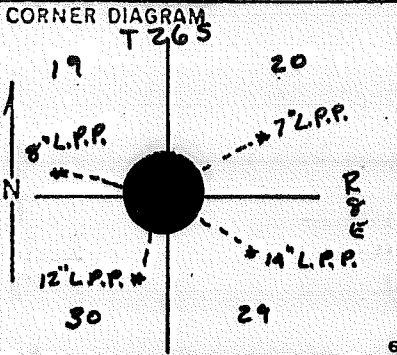

DESCRIBE CORNER MONUMENT FOUND
S. F. / N. F.

PHOTO IDENTIFICATION DATA
Photo No. _____
Filed At. _____
Object Ident. _____
Ident. By _____
Signature

DESCRIBE BEARING TREES OR OTHER OFFICIAL ACCESSORIES FOUND
Sec. 19 12" Pine snag scribing visible
Sec. 20 8" Pine scribing visible
Sec. 29 14" Pine No visible scribing
Sec. 30 6" Pine down scribing visible.

PLANE COORDINATE POSITION DATA
State _____ Zone _____
X _____
Y _____
Estab. By _____
Agency

DESCRIBE CORNER LOCATION RELATIVE TO NEAR-BY FEATURES, ALSO HOW TO REACH CORNER
400' west of location poster on power line Road.

Signature
Hildebrand

Title _____ Division _____ Headquarters _____

Date
7/79

CORNER RECORD (PERPETUATION)

MONUMENT
STAMPED:

MONUMENT: DESCRIBE NEW MONUMENT SET, OR WORK DONE TO PRESERVE EXISTING MONUMENT

Set 2 1/2" x 32" Brasscapped Steel Pipe
rising 6" above the ground Stamped as shown.

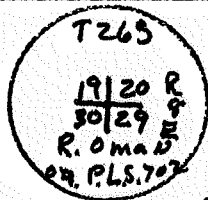

ACCESSORIES: DESCRIBE NEW BT's WITNESS OBJECTS ETC. ESTABLISHED, OR WORK DONE TO PRESERVE EXISTING EVIDENCE

- a. 8" Lodgepole Pine bears N 70° W 6.7 feet (Original BT.)
- a 7" Lodgepole Pine bears N 59° E 17.8 feet B/S "T265 R8E S 20 BT"
- a 14" Lodgepole Pine bears S 41° E 9.8 feet (Original BT.)
- a 12" Lodgepole Pine bears S 26° W 59.8 feet B/S "T265 R8E S 30 BT"

Work Done By R. OMAN Title PLS Date 7/79 State Registration No. OR-702
or Agency
Certified Cor. Record Prepared? No Filed At: Klamath Co. Date

REMARKS

Index
File No. R-6

CORNER RECORD (SEARCH)
(Ref. FSM 7.151.4)

Tract or
Survey No. _____

Cor.
No. R-6

T. 26 S. R. 8 E. R.D. Crescent

County Deschutes

W 1/16 COR. of SEC. 20

Merid. WILLAMETTE

N.F. DESCHUTES State OREGON

W 1/16 COR. of SEC. 29

CORNER DIAGRAM PER LEGEND

DESCRIBE CORNER MONUMENT FOUND

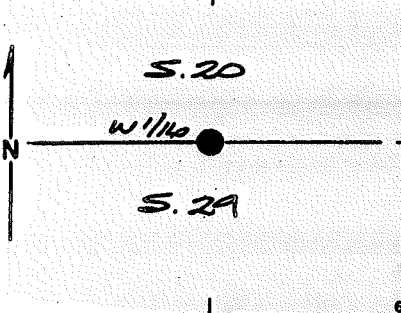

NONE

DESCRIBE BEARING TREES OR OTHER OFFICIAL ACCESSORIES FOUND

NONE

PHOTO IDENTIFICATION DATA

Photo No. _____
Filed At. _____
Object Ident. _____
Ident. By _____
Signature

DESCRIBE CORNER LOCATION RELATIVE TO NEAR-BY FEATURES, ALSO HOW TO REACH CORNER

Turn West on a road which is 1 mile South from the junction of hwy. 97 and 58. Proceed on road for approximately 1.2 miles to a junction. Go South on for approximately 1.5 miles to the intersection of the section line. Corner is ± 2800 feet West of location Poster.

Corner Legend:

- Searched for/Not Found
- Evidence Found/Accept.
- Permanent Monument

Signature
W. H. Jones

Title
SURVEYOR

Division
ORE.

Headquarters
RPLS 930

Date
12/7/81

D-7100-52 (3/79)

CORNER RECORD (PERPETUATION)

MONUMENT STAFFED

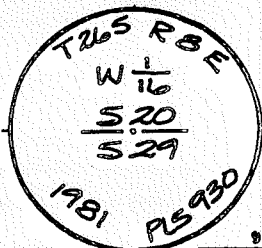

MONUMENT. DESCRIBE NEW MONUMENT SET, OR WORK DONE TO PRESERVE EXISTING MONUMENT

Set 2-1/2" x 30" Aluminum Pipe with cap 6" above ground
 Set fibreglass post with 54-2 and 54-9 sign on section line
 near cap. Also set fibreglass post with 54-2 sign on 1/16
 line near cap

ACCESSORIES DESCRIBE NEW BT'S WITNESS OBJECTS ETC. ESTABLISHED, OR WORK DONE TO PRESERVE EXISTING EVIDENCE

11" Lodgepole Pine bearing N04°W at 44.38 feet, scribed "W 1/16 S20 - BT"
 7" Lodgepole Pine bearing S 88°W at 14.00 feet, scribed "W 1/16 S29 - BT"
 Nailed brass washers with #930 to faces.
 Painted blazes and 6" bands with red paint.
 Nailed 54-3 and 54-9 signs on B.T.'s.

Work Done By R. H. GRAVE Title SURVEYOR Date 1/7/81 State Registration No. ORLS # 930
 or Agency
 PLAT PREPARED OR Certified Cor. Record Prepared? Yes No Filed At: Co. SURVEYOR'S OFFICE Date

REMARKS

Index File No. R-6 T. 26 S., R. 8 E., W.M. Tract or Surv. No. W 1/16 Cor. S29

USDA-FOREST SERVICE

Index File No. R-7

CORNER RECORD (SEARCH)

(Ref. FSM 7.151.4)

Tract or Survey No. _____

Cor. No. R-7

T. 26 S. R. 8

E. R.D. _____

County Deschutes

S 1/4 Cor. of Sec. 20

Merid. WILLAMETTE

N.F. DESCHUTES

State OREGON

N 1/4 Cor. of Sec. 29

CORNER DIAGRAM PER LEGEND

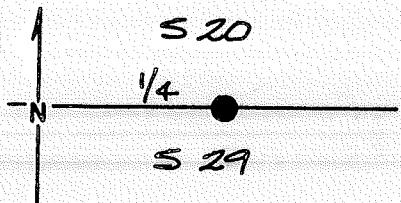

DESCRIBE CORNER MONUMENT FOUND

Searched for and not found

DESCRIBE BEARING TREES OR OTHER OFFICIAL ACCESSORIES FOUND

Searched for and not found

PHOTO IDENTIFICATION DATA

Photo No. _____

Filed At. _____

Object Ident. _____

Ident. By _____

Signature

Corner Legend:

Searched for/Not Found

Evidence Found/Accept.

Permanent Monument

DESCRIBE CORNER LOCATION RELATIVE TO NEAR-BY FEATURES, ALSO HOW TO REACH CORNER

Turn West on a road which is 1 mile South from the Junction of Hwy. 97 and 58. Proceed on road for approximately 1.2 miles to a junction. Go South on for approximately 1.5 miles to the intersection of the section line. Corner is \pm 1500 feet West of location poster.

Signature

Paul H. Lane

Title

SURVEYOR

Division

ORE.

Headquarters

RPLS 930

1/7/81

D-7100 52 (3/79)

CORNER RECORD (PERPETUATION)

MONUMENT DESCRIBE NEW MONUMENT SET, OR WORK DONE TO PRESERVE EXISTING MONUMENT

Set 2-1/2" x 30" Aluminim Pipe with cap extending 6" above ground
 Set two fibreglass posts near cap on section line with 54-2 signs.
 One post also has 54-4 sign.

MONUMENT SET

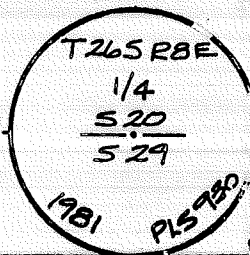

ACCESSORIES DESCRIBE NEW BT'S WITNESS OBJECTS ETC. ESTABLISHED, OR WORK DONE TO PRESERVE EXISTING EVIDENCE

13" Ponderosa Pine bearing S16°W at 19.92 feet, scribed "1/4 S29 - BT"
 14" Ponderosa Pine bearing N38°W at 12.42 feet, scribed "1/4 S20 - BT"
 Nailed brass washers with #930 to faces
 Painted blazes and 6" bands with red paint
 Nailed 54-3 and '54-4 signs on B.T.'s

Work Done By R. H. GRAVE Title SURVEYOR Date 1/7/81 State Registration No. ORLS # 930
 or Agency
 PLAT PREPARED OR
 Certified Cor Record Prepared? Yes No Filed At: Co. SURVEYOR'S OFFICE Date

REMARKS

Index File No. R-7 T. 26 S., R. 8 E., W.M. Tract or Surv. No. N 1/4 Cor. 29

Index
 File No. R-8
 T. 26 S. R. 8 E. R. D. _____
 Mer id. WILLAMETTE

CORNER RECORD (SEARCH)
 (Ref. FSM 7.151.4)

Tract or Survey No. _____
 County Deschutes State OREGON
 Cor. No. R-8
 E 1/16 Cor. of Sec. 20
 E 1/16 Cor. of Sec. 29

CORNER DIAGRAM PER LEGEND

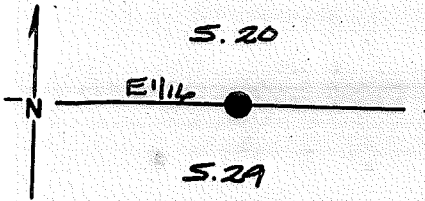

DESCRIBE CORNER MONUMENT FOUND

NONE

DESCRIBE BEARING TREES OR OTHER OFFICIAL ACCESSORIES FOUND

NONE

PHOTO IDENTIFICATION DATA

Photo No. _____
 Filed At _____
 Object Ident. _____
 Ident. By _____
 Signature _____

DESCRIBE CORNER LOCATION RELATIVE TO NEAR-BY FEATURES, ALSO HOW TO REACH CORNER

Turn West on a road which is 1 mile South from the Junction of Hwys. 97 and 58. Proceed on road for approximately 1.2 miles to a junction. Go South on for approximately 1.5 miles to the intersection of the section line. Corner is \pm 200 feet West of location poster

- Corner Legend:
 Searched for/Not Found
 Evidence Found/Accept.
 Permanent Monument

Signature [Handwritten Signature]

Title SURVEYOR Division ORE. Headquarters RPLS 930 Date 11/7/81
 O-7100-52 (3/79)

CORNER RECORD (PERPETUATION)

MONUMENT SET

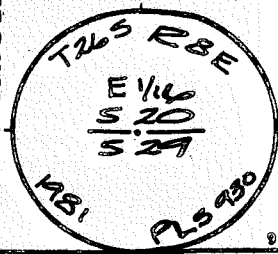

MONUMENT DESCRIBE NEW MONUMENT SET, OR WORK DONE TO PRESERVE EXISTING MONUMENT

Set 2-1/2" x 30" Aluminum Pipe with cap extending 6" above ground.
 Set fibreglass post on section line near cap with 54-2 and 54-9 sign. Also set fibreglass post near cap with 54-2 sign on 1/16 line.

ACCESSORIES DESCRIBE NEW BT'S WITNESS OBJECTS ETC. ESTABLISHED, OR WORK DONE TO PRESERVE EXISTING EVIDENCE

24" Ponderosa Pine bearing N11°W at 75.14 feet, scribed "E 1/16 S20 - BT"
 18" Ponderosa Pine bearing S65°W at 14.75 feet, scribed "E 1/16 S29 - BT"
 Nailed brass washers with #930 to faces.
 Painted blazes and 6" bands with red paint.
 Nailed 54-3 and 54-9 signs on B.T.'s.

Work Done By R.H. GRAUE Title SURVEYOR Date 1/7/81 State Registration No. or Agency ORLS # 930
 Certified Cor. Record Prepared? Yes No Filed At: Co. SURVEYOR'S OFFICE Date _____

REMARKS

Index File No. R-8 T. 26 S., R. 8 E., W.M. E. W.M. Tract or Surv. No. E 1/16 Cor. S.29

USDA-FOREST SERVICE

Index File No. 0967

CORNER RECORD (SEARCH)
(Ref. FSM 7151.4)

Tract or Survey No. _____

Cor. No. R-09

T 26 S. R. 8 E. R.D. CRESCENT County KLAMATH NG COR. Sec 29

Merid. WILLAMETTE N.F. DESCHUTES State OREGON SW COR. Sec 21

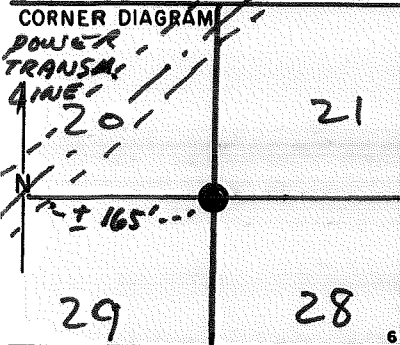

DESCRIBE CORNER MONUMENT FOUND

- NONE -

DESCRIBE BEARING TREES OR OTHER OFFICIAL ACCESSORIES FOUND

18" L. PINE BR. N68°W 33 FT., VIS. SCR. "S20"
a ROTTED LOG BR. N64°E 26 1/4 FT. - ED. TOE BLAZE AND SHARDS OF FACE BLAZE - SCRIBING WEATHERED OUT

PHOTO IDENTIFICATION DATA

Photo No. _____
Filed At. _____
Object Ident. _____
Ident. By _____
Signature

DESCRIBE CORNER LOCATION RELATIVE TO NEAR-BY FEATURES, ALSO HOW TO REACH CORNER

PLANE COORDINATE POSITION DATA

State _____ Zone _____
X _____
Y _____
Estab. By _____
Agency

Signature R. OMAN Title PLS Division _____ Headquarters SO Date 6/80 D-7100-52 (10/78)

CORNER RECORD (PERPETUATION)

MONUMENT: DESCRIBE NEW MONUMENT SET, OR WORK DONE TO PRESERVE EXISTING MONUMENT

SET 2 1/2" X 32" BRASS-CAPPED STEEL PIPE RISING 5" ABOVE GROUND, ON GENTLE WEST SLOPE, ABOUT 165' EAST OF EAST R/W CLG. FOR POWER TRANSMISSION LINE.

T265
1980
R
E
20121
29128
R.OMAN PLS
OR-702

MONUMENT
STAMPED

ACCESSORIES DESCRIBE NEW BT'S WITNESS OBJECTS ETC. ESTABLISHED, OR WORK DONE TO PRESERVE EXISTING EVIDENCE

7" L. PINE BRS. N84°W 9⁹³ FT. TO 60d SPIKE IN S. BASE, MKD. T265 R8E5 20BT
6" " " N68°E 20³⁹ FT. " " " " N. " " " " 521 BT
8" R. PINE " S33°E 60²² FT. " " " " NE " " " " 528 BT
6" L. PINE " S12°W 18⁷³ FT. " " " " E. " " " " 529 BT

Work Done By R. OMAN Title PLS Date 6/80 State Registration No. OR-702
Certified Cor. Record Prepared? Yes No Filed At KLAM. CO. SURVEYORS OFFICE Date 6/80

REMARKS

Index File No. 0967 T. 26 S., R. 8 E., W.M.

Tract or Surv. No.

Cor. R-09

Index File No. 1367

CORNER RECORD (SEARCH). Contract or Survey No. (Ref. FSM 7151.4)

Cor. No. R-13

T 26 S. R. 8 E. R.D. Crescent County Klamath SE Cor. of

Merid. Willamette N.F. Deschutes State Oregon Section 21

CORNER DIAGRAM per legend

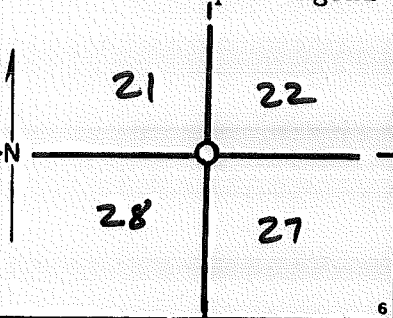

DESCRIBE CORNER MONUMENT FOUND

SFNF

DESCRIBE BEARING TREES OR OTHER OFFICIAL ACCESSORIES FOUND

SFNF - AREA FALLS IN CLEARCUT.

PHOTO IDENTIFICATION DATA

Photo No. _____
Filed At. _____
Object Ident. _____
Ident. By _____
Signature

DESCRIBE CORNER LOCATION RELATIVE TO NEAR-BY FEATURES, ALSO HOW TO REACH CORNER

CORNER LEGEND:

FS or Contr.	Unverified Other	
○	◇	Searched For/Not Found
⊗	⊗	Evidence Found/Accept.
●	◆	Permanent Mon. Set/Fd.

Searched By: _____ Title _____ Division _____ Headquarters _____ Date _____

SC/OS

ST

CS

SO

6-5-84

CORNER RECORD (PERPETUATION)

MONUMENT: DESCRIBE NEW MONUMENT SET, OR WORK DONE TO PRESERVE EXISTING MONUMENT

MONUMENT STAMPED

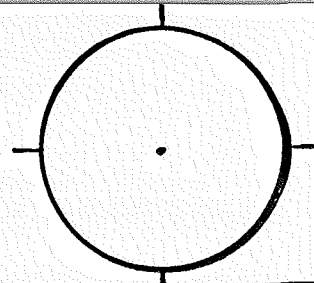

9

ACCESSORIES : DESCRIBE NEW BT'S WITNESS OBJECTS ETC. ESTABLISHED, OR WORK DONE TO PRESERVE EXISTING EVIDENCE

10

Work Done By _____ Title _____ Date _____ State Registration No. _____
or Agency _____
Plat or Certified Cor. Record Prepared? Yes No Filed At: Co. Surveyor's Office Date _____

11

History
of
Surveys,
G.L.O.,
etc.

12

Index File No. 1367 T. 26 S., R. 8 E., W.M. Contract or Surv. No. Cor. R-13

USDA-FOREST SERVICE

Index

File No. _____

CORNER RECORD (SEARCH)

(Ref. FSM 7151.4)

Tract or

Survey No. _____

Cor.

No. T-5

T 26S R. 8E

R.D. Crasant

County Klamath

Merid. Will

N.F. Daschute

State Oregon

CORNER DIAGRAM

DESCRIBE CORNER MONUMENT FOUND

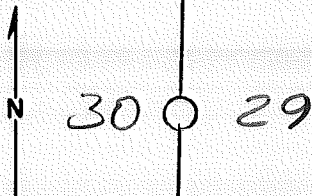

searched for - found nothing

DESCRIBE BEARING TREES OR OTHER OFFICIAL ACCESSORIES FOUND

PHOTO IDENTIFICATION DATA

Photo No. _____

Filed At. _____

Object Ident. _____

Ident. By _____

Signature

PLANE COORDINATE POSITION DATA

State _____ Zone _____

X _____

Y _____

Estab. By _____

Agency

Signature

Title

Division

Headquarters

Date

7100-52-(3/68)

Dan Sankwich

Survey Tech

Eng

SO.

6/78

CORNER RECORD (PERPETUATION)

MONUMENT : DESCRIBE NEW MONUMENT SET, OR WORK DONE TO PRESERVE EXISTING MONUMENT

9

ACCESSORIES : DESCRIBE NEW BT's WITNESS OBJECTS ETC. ESTABLISHED, OR WORK DONE TO PRESERVE EXISTING EVIDENCE

10

Work Done By _____ Title _____ Date _____ State Registration No. or Agency _____

Certified Cor. Record Prepared ? Yes No Filed At: _____ Date _____

11

REMARKS

Index File No. T. R. M. Tract or Surv. No. Cor. 12
U.S. G.P.O. 1977-72-576-586 13
7-05 14

CORNER RECORD (SEARCH)

(Ref. FSM 7151.4)

Index File No. V-1

Tract or Survey No. _____

Cor. No. V-01

T 26S R. 8E

R.D. Crescent

County Klamath

Section _____

Merid. Will

N.F. Deschutes

State Oregon

CORNER DIAGRAM

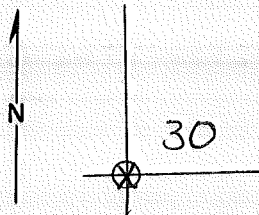

DESCRIBE CORNER MONUMENT FOUND

SEE = V-25, T26S, R7E

DESCRIBE BEARING TREES OR OTHER OFFICIAL ACCESSORIES FOUND

E.V.F.D.

PHOTO IDENTIFICATION DATA

Photo No. _____

Filed At. _____

Object Ident. _____

Ident. By _____

Signature

PLANE COORDINATE POSITION DATA

State _____ Zone _____

X _____

Y _____

Estab. By _____

Agency

Signature

Title

Division

Headquarters

Date

7100-52 (3/68)

CORNER RECORD (PERPETUATION)

MONUMENT : DESCRIBE NEW MONUMENT SET, OR WORK DONE TO PRESERVE EXISTING MONUMENT

9

ACCESSORIES : DESCRIBE NEW BT's WITNESS OBJECTS ETC. ESTABLISHED, OR WORK DONE TO PRESERVE EXISTING EVIDENCE

10

Work Done By _____ Title _____ Date _____ State Registration No. or Agency _____

Certified Cor. Record Prepared ? Yes No Filed At: _____ Date _____

11

REMARKS

Index File No. T. R. M. Tract or Surv. No. Cor. **V-01**

12

13

INDEX
File No. 0371

CORNER RECORD (SEARCH)
(Ref. FSM 7151.4)

Tract or Survey No. _____
Cor. No. V-03

T 26S R. 8E

R.D. Crescent County Klamath

Merid. W. M.

N.F. Deschutes State Oregon

CORNER DIAGRAM

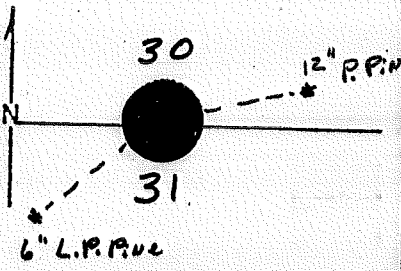

DESCRIBE CORNER MONUMENT FOUND

S. F. N. F.

DESCRIBE BEARING TREES OR OTHER OFFICIAL ACCESSORIES FOUND

found SE BT Scribing Visible

PHOTO IDENTIFICATION DATA

Photo No. _____
Filed At. _____
Object Ident. _____
Ident. By _____
Signature

DESCRIBE CORNER LOCATION RELATIVE TO NEAR-BY FEATURES, ALSO HOW TO REACH CORNER

250' East of logging & 500' N of a dead cow

PLANE COORDINATE POSITION DATA

State _____ Zone _____
X _____
Y _____
Estab. By _____
Agency

Signature _____ Title _____ Division _____ Headquarters _____ Date _____

Hildebrand

7/79

7100-52 (3 63)

CORNER RECORD (PERPETUATION)

MONUMENT
STAMPED:

MONUMENT: DESCRIBE NEW MONUMENT SET, OR WORK DONE TO PRESERVE EXISTING MONUMENT

Set 2 1/2 x 32" Brass Capped Steel P.ipe
rising 7" above the Ground Stamped as shown.

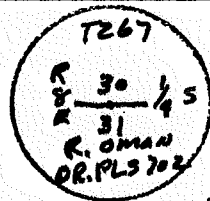

ACCESSORIES : DESCRIBE NEW BT'S WITNESS OBJECTS ETC. ESTABLISHED, OR WORK DONE TO PRESERVE EXISTING EVIDENCE

a 12" Pondaros Pine bears N79°E 47.9 ft B/s "1/4 S 30 BT"
a 6" Lodgepole Pine bears S27°W 48.3 ft B/s "1/4 S 31 BT"

Work Done By _____ Title _____ Date 7/79 State Registration No. OR. L.S. 702
or Agency

Certified Cor. Record Prepared? (Yes) No Filed At: Klamath Co. Date _____

REMARKS

Index
File No. 0571

CORNER RECORD (SEARCH)
(Ref. FSM 7151.4)

Tract or Survey No. _____
Cor. No. V-05

T 265 R. 8E
Merid. Will

R.D. Crescent County Klamath
N.F. Deschutes State Oregon

CORNER DIAGRAM

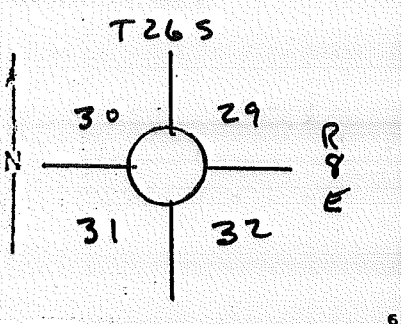

DESCRIBE CORNER MONUMENT FOUND

Searched for, Nothing Found

DESCRIBE BEARING TREES OR OTHER OFFICIAL ACCESSORIES FOUND

S. F. N. F.

PHOTO IDENTIFICATION DATA

Photo No. _____
Filed At. _____
Object Ident. _____
Ident. By _____
Signature

DESCRIBE CORNER LOCATION RELATIVE TO NEAR-BY FEATURES, ALSO HOW TO REACH CORNER

PLANE COORDINATE POSITION DATA

State _____ Zone _____
X _____
Y _____
Estab. By _____
Agency

Hildebrand

Title _____ Division _____ Headquarters _____

1/79

Index
File No. 0571

CORNER RECORD (SEARCH)
(Ref. FSM 7151.4)

Tract or Survey No. _____
Cor. No. V-05

T 265 R. 8E

R.D. Crescent County Klamath

Merid. Will

N.F. Deschutes State Oregon

CORNER DIAGRAM

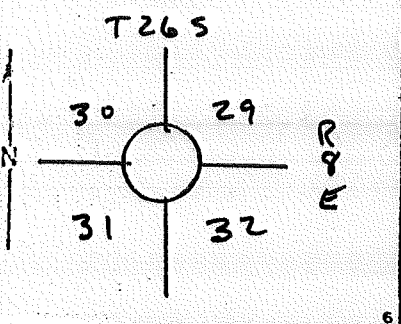

DESCRIBE CORNER MONUMENT FOUND

Searched for. Nothing Found

DESCRIBE BEARING TREES OR OTHER OFFICIAL ACCESSORIES FOUND

S. F. N. F.

PHOTO IDENTIFICATION DATA

Photo No. _____
Filed At. _____
Object Ident. _____
Ident. By _____
Signature

DESCRIBE CORNER LOCATION RELATIVE TO NEAR-BY FEATURES, ALSO HOW TO REACH CORNER

PLANE COORDINATE POSITION DATA

State _____ Zone _____
X _____
Y _____
Estab. By _____
Agency

Hildebrand

Title _____ Division _____ Headquarters _____

1/79

Index File No. 0771
T 265 R. 8E
Merid. Will.

CORNER RECORD (SEARCH)
(Ref. FSM 7151.4)

Tract or Survey No. _____
Cor. No. V-07

R.D. Crescent County Klamath
N.F. Deschutes State Oregon

CORNER DIAGRAM

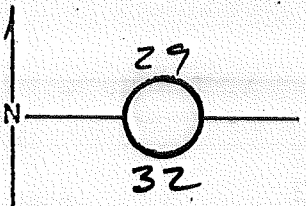

DESCRIBE CORNER MONUMENT FOUND

DESCRIBE BEARING TREES OR OTHER OFFICIAL ACCESSORIES FOUND

PHOTO IDENTIFICATION DATA

Photo No. _____
Filed At. _____
Object Ident. _____
Ident. By _____
Signature

DESCRIBE CORNER LOCATION RELATIVE TO NEAR-BY FEATURES, ALSO HOW TO REACH CORNER

PLANE COORDINATE POSITION DATA

State _____ Zone _____
X _____
Y _____
Estab. By _____
Agency

Signature _____ Title _____ Division _____ Headquarters _____ Date _____ 7100-52 (3 68)

Index File No. 0971
T 26S R. 8E
Merid. W:11

CORNER RECORD (SEARCH)
(Ref. FSM 7151.4)

Tract or Survey No. _____
Cor. No. V-09

R.D. Crescent County Klamath
N.F. Deschutes State Oregon

CORNER DIAGRAM

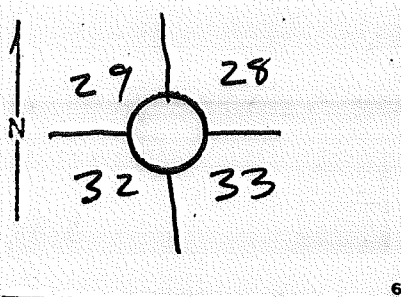

DESCRIBE CORNER MONUMENT FOUND

Searched For. Nothing Found.

DESCRIBE BEARING TREES OR OTHER OFFICIAL ACCESSORIES FOUND

S. F. N. F.

PHOTO IDENTIFICATION DATA

Photo No. _____
Filed At. _____
Object Ident. _____
Ident. By _____
Signature

DESCRIBE CORNER LOCATION RELATIVE TO NEAR-BY FEATURES, ALSO HOW TO REACH CORNER

PLANE COORDINATE POSITION DATA

State _____ Zone _____
X _____
Y _____
Estab. By _____
Agency

Signature
Hildebrand

Title _____ Division _____ Headquarters _____ Date *7/79*

INDEX
File No. 1171
T 265 R. 8E
Merid. Will

CORNER RECORD (SEARCH)
(Ref. FSM 7151.4)

Tract or Survey No. _____
Cor. No. V-11

R.D. Crescent County Klamath
N.F. Deschute State Oregon

CORNER DIAGRAM

DESCRIBE CORNER MONUMENT FOUND

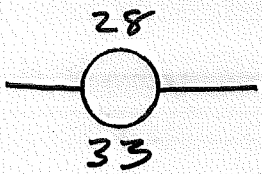

Searched For Nothing Found

DESCRIBE BEARING TREES OR OTHER OFFICIAL ACCESSORIES FOUND

S. F. N. F.

PHOTO IDENTIFICATION DATA

Photo No. _____
Filed At. _____
Object Ident. _____
Ident. By _____
Signature _____

DESCRIBE CORNER LOCATION RELATIVE TO NEAR-BY FEATURES, ALSO HOW TO REACH CORNER

PLANE COORDINATE POSITION DATA

State _____ Zone _____

Established By _____
Agency _____

Signature Hildebrand

Title _____ Division _____ Headquarters _____ Date 7/79

Index
File No. 1371
T. 26S R. 8E
Merid. Will.

CORNER RECORD (SEARCH)
(Ref. FSM 7151.4)

Tract or Survey No. _____
Cor. No. V-13

R.D. Crescent County Klamath
N.F. Deschutes State Oregon.

CORNER DIAGRAM

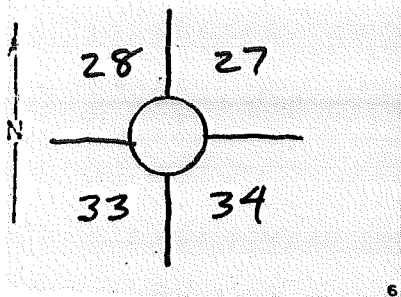

DESCRIBE CORNER MONUMENT FOUND

Search For Nothing Found

DESCRIBE BEARING TREES OR OTHER OFFICIAL ACCESSORIES FOUND

S. F. N. F

PHOTO IDENTIFICATION DATA

Photo No. _____
Filed At. _____
Object Ident. _____
Ident. By _____
Signature

DESCRIBE CORNER LOCATION RELATIVE TO NEAR-BY FEATURES, ALSO HOW TO REACH CORNER

PLANE COORDINATE POSITION DATA

State _____ Zone _____
X _____
Y _____
Estab. By _____
Agency

Hildebrand

Title _____ Division _____ Headquarters _____ Date 7/79

LAND CORNER RECORD

X-05 5680-2

(Rectangular)

1. T. 26S R. 8E No. X-5 Cor. 1/4 Mer. WILL State OREGON N. F. DESCHUTES Dist. CRESCENT

2. Corner Status

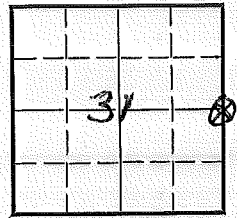

3. Original Description Vol. Page Where Recorded

4. Description of Corners:
SF/NF

5. Investigation Notes: 1/4 Corner common to Secs. 32 and 31.
Corner consists of a stake in good condition. Dimensions above ground 44x2x2 inches.

7. Photo Identification

Photo No. _____
Ident. By: _____

Bearing Tree: *all lies*
PP - 31.2" dia., 148°, 18.5'
Metal location poster is on a PP tree 31" dia., on the NW face of tree from which this corner bears 328°, 18.5 feet.

8. Plane Coordinate Position Data

State _____ Zone _____
X _____
Y _____
Estab. By _____
Field Book No. _____
Where Filed _____

Not in this TP. file

9. Evaluation

Authentic _____
Needs Verif. _____ Monument _____
Re-estab. _____ Survey _____
Land Status _____

6. Signed *D. Bowditch* Title FORESTER Date *4-8-60*

Index
File No. 0575
T 26 S R. 8 E
Merid. Willamette

CORNER RECORD (SEARCH)
(Ref. FSM 7151.4)

Tract or Survey No. _____
Cor. No. 2-05
R.D. Crescent County Klamath
N.F. Deschutes State Oregon

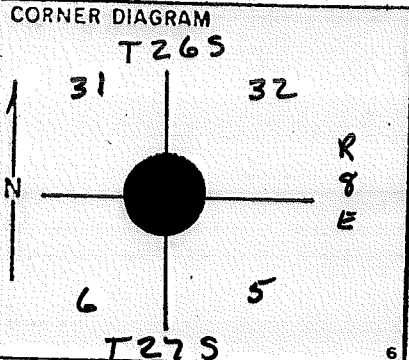

DESCRIBE CORNER MONUMENT FOUND
S. F. N. F.

DESCRIBE BEARING TREES OR OTHER OFFICIAL ACCESSORIES FOUND
Sec. 32 11 1/2 Pine Scribing Visible
Sec. 6 32" Pine No Visible Scribing.

PHOTO IDENTIFICATION DATA
Photo No. _____
Filed At. _____
Object Ident. _____
Ident. By _____
Signature

DESCRIBE CORNER LOCATION RELATIVE TO NEAR-BY FEATURES, ALSO HOW TO REACH CORNER
600' west of road along Rail Road tracks.
Southern Pacific.

PLANE COORDINATE POSITION DATA
State _____ Zone _____
X _____
Y _____
Estab. By _____
Agency

Signature Hildebrand Title _____ Division _____ Headquarters _____ Date 7/79
7100-52 (3 68)

CORNER RECORD (PERPETUATION)

MONUMENT
STAMPED:

MONUMENT: DESCRIBE NEW MONUMENT SET, OR WORK DONE TO PRESERVE EXISTING MONUMENT

Set 2 1/2" x 32" Brass Capped Steel Pipe rising
5" above the Ground Stamped as shown.

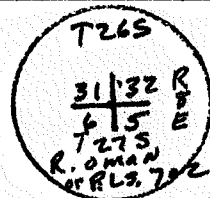

ACCESSORIES: DESCRIBE NEW BT'S WITNESS OBJECTS ETC. ESTABLISHED, OR WORK DONE TO PRESERVE EXISTING EVIDENCE

- a 32" Ponderosa pine bears S 90° W 33.0 ft (Original Bt.)
- a 7" Ponderosa Pine bears N 26° W 27.0 ft. B/s. "T265 R8E S31 BT"
- a 7" ~~Ponderosa~~ ^{Lodgepole} Pine bears N 38° E 28.8 ft. B/s "T265 R8E S32 BT"
- a 7" Lodgepole Pine bears S 30° E 31.0 ft B/s "T275 R8E S5 BT"

Work Done By. R. OMAN Title PLS Date 7/79 State Registration No. OR. P.L.S. 702
or Agency
Certified Cor. Record Prepared? No Filed At: Klamath Co. Date

REMARKS

USDA-FOREST SERVICE

Index File No. 0975

CORNER RECORD (SEARCH)
(Ref. FSM 7151.4)

Tract or Survey No. _____
Cor. No. 2-09

T 26 S. R. 8 E. R.D. CRESCENT County KLAMATH SE Cor. Sec. 32

Merid. WILLAMETTE N.F. DESCHUTES State OREGON SW Cor. Sec. 33

CORNER DIAGRAM

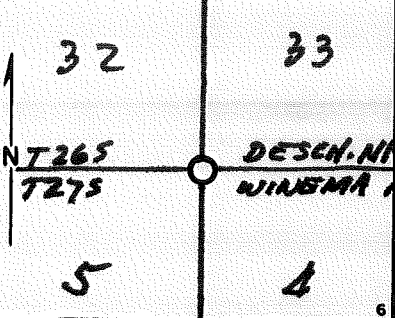

DESCRIBE CORNER MONUMENT FOUND

SF/NF

DESCRIBE BEARING TREES OR OTHER OFFICIAL ACCESSORIES FOUND

SF/NF

PHOTO IDENTIFICATION DATA

Photo No. _____
Filed At. _____
Object Ident. _____
Ident. By _____
Signature _____

DESCRIBE CORNER LOCATION RELATIVE TO NEAR-BY FEATURES, ALSO HOW TO REACH CORNER

PLANE COORDINATE POSITION DATA

State _____ Zone _____
X _____
Y _____
Estab. By _____
Agency _____

Signature R. OMAN Title PLS Division _____ Headquarters S.O. Date 6/86 D-7100-52 (10/78)

CORNER RECORD (PERPETUATION)

MONUMENT: DESCRIBE NEW MONUMENT SET, OR WORK DONE TO PRESERVE EXISTING MONUMENT

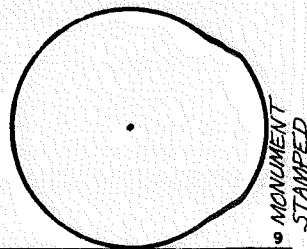

ACCESSORIES DESCRIBE NEW BT'S WITNESS OBJECTS ETC. ESTABLISHED, OR WORK DONE TO PRESERVE EXISTING EVIDENCE

Work Done By _____ Title _____ Date _____ State Registration No. _____
or Agency _____
Certified Cor. Record Prepared? Yes No Filed At: _____ Date _____

REMARKS

Index File No. 0975 T. 26 S., R. 8 E., W.M. Tract or Surv. No. _____ Cor. 2-09

USDA-FOREST SERVICE

Index File No. 0975

CORNER RECORD (SEARCH)
(Ref. FSM 7151.4)

Tract or Survey No. 2-09

T 26 S. R. 8 E. R.D. CRESCENT County KLAMATH SE Cor. Sec 32

Merid. WILLAMETTE N.F. DESCHUTES State OREGON SW Cor. Sec. 33

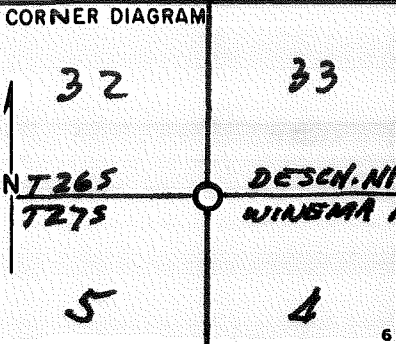

DESCRIBE CORNER MONUMENT FOUND

SF/NF

DESCRIBE BEARING TREES OR OTHER OFFICIAL ACCESSORIES FOUND

SF/NF

PHOTO IDENTIFICATION DATA

Photo No. _____

Filed At. _____

Object Ident. _____

Ident. By _____

Signature _____

DESCRIBE CORNER LOCATION RELATIVE TO NEAR-BY FEATURES, ALSO HOW TO REACH CORNER

PLANE COORDINATE POSITION DATA

State _____ Zone _____

X _____

Y _____

Estab. By _____

Agency _____

Signature R. OMAN Title PLS Division _____ Headquarters S.O. Date 6/86 D-7100-52 (10/78)

USDA-FOREST SERVICE

Index
File No. B2575

CORNER RECORD (SEARCH)

(Ref. FSM 7151.4)

Tract or
Survey No. _____

Cor.
No. 2-25

T 26 S. R. 8 E.

R.D. Crescent

County Klamath

SE COR SEC. 36

Merid. WILLAMETTE

N.F. DESCHUTES

State OREGON

CORNER DIAGRAM

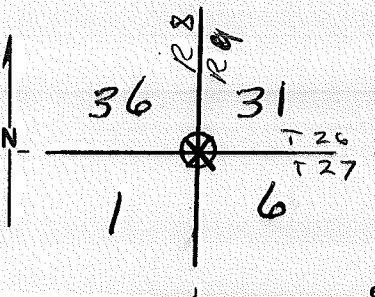

DESCRIBE CORNER MONUMENT FOUND

Corner Common to Sections 36, 1, and 6.
Corner consists of a Stake in place, broken at ground level.
Triangular 4x4", 36" inches.

DESCRIBE BEARING TREES OR OTHER OFFICIAL ACCESSORIES FOUND

PP. dia. 19.1" bears 222° 22'
Believed to be a genuine Land office corner.

PHOTO IDENTIFICATION DATA

Photo No. _____
Filed At. _____
Object Ident. _____
Ident. By _____
Signature _____

DESCRIBE CORNER LOCATION RELATIVE TO NEAR-BY FEATURES, ALSO HOW TO REACH CORNER

PLANE COORDINATE POSITION DATA

State _____ Zone _____
X _____
Y _____
Estab. By _____
Agency _____

Signature George Niskala

Title Forester

Division _____

Headquarters _____

Date 4-15-60

D-7100-52 (10/78)